

Single, Two and Three Phase Connection Diagram

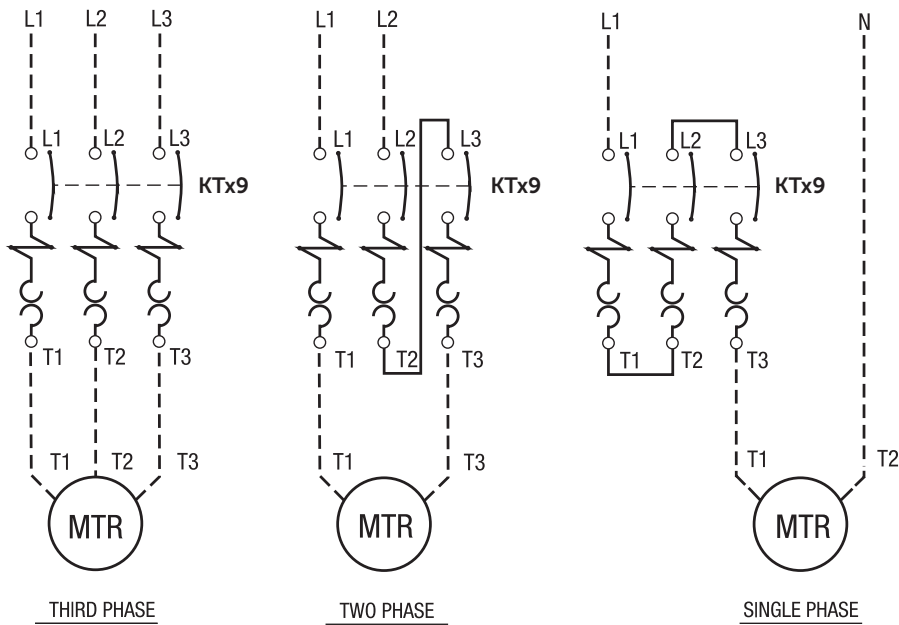

THIRD PHASE

TWO PHASE

SINGLE PHASE

**Type E/F Combination Controller Full Voltage Non-Reversing
AC Control with D7 Series Pilot Devices**

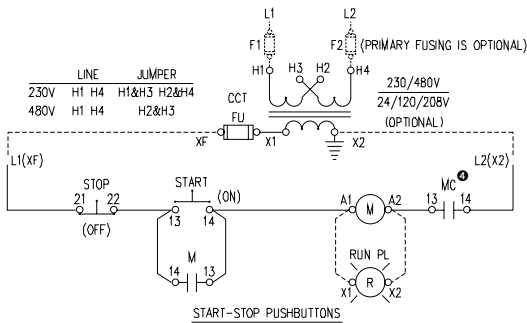

START-STOP PUSHBUTTONS

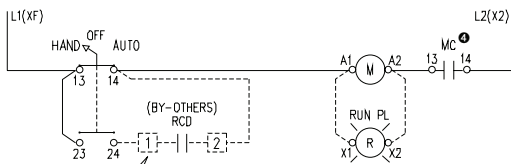

HAND-OFF-AUTO SELECTOR SWITCH

WIRE AS SHOWN WHEN OPTIONAL TERMINAL BLOCKS ARE PROVIDED

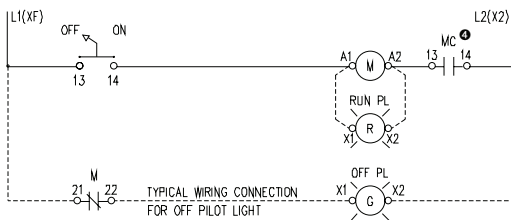

OFF-ON SELECTOR SWITCH

TYPICAL WIRING CONNECTION FOR OFF PILOT LIGHT

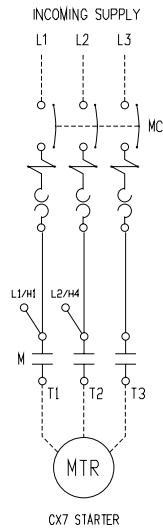

CX7 STARTER

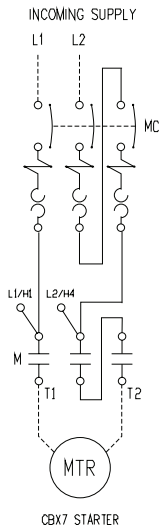

CBX7 STARTER

NOTES:

- 1) RCD: STANDS FOR REMOTE CONTROL DEVICE BY CUSTOMER
- 2) MC: KT7 "TYPE E" MOTOR CONTROLLER
- 3) X2 TERMINAL GROUNDED AS STANDARD, REMOVE GROUND IF NOT REQUIRED
- 4) TYPICAL FOR CONTROL CIRCUITS 300V AC OR LESS

F

Enclosed Motor Circuit Controllers

Enclosures

See Enclosure Dimension Charts on Previous Page.

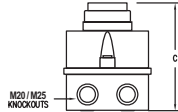
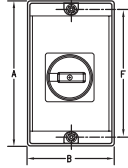
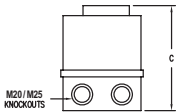
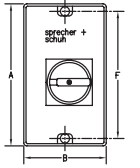

FIGURE NO. 1

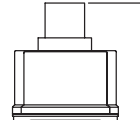
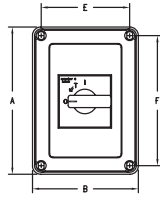

FIGURE NO. 2

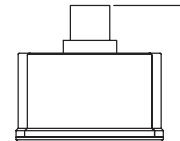
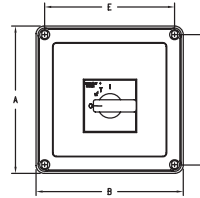

FIGURE NO. 3

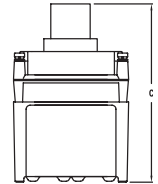
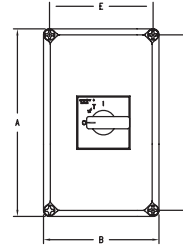
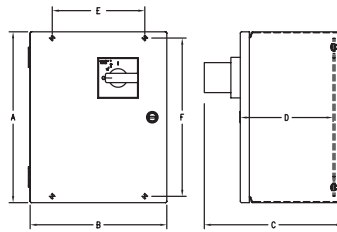

FIGURE NO. 4



TYPE 4/12
FIGURE NO. 5

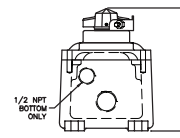
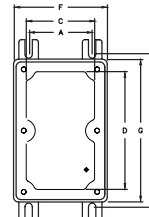
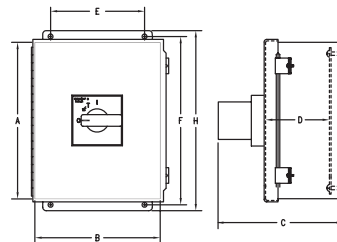

FIGURE NO. 7



TYPE 12
FIGURE NO. 6

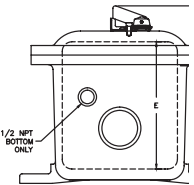
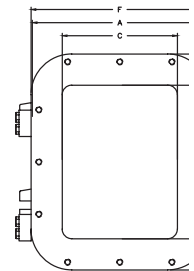

FIGURE NO. 8