

**sprecher+schuh** PCS / PDS Auxiliary  
**Installation Instructions**  
 (Cat PCS-PA- \_\_)

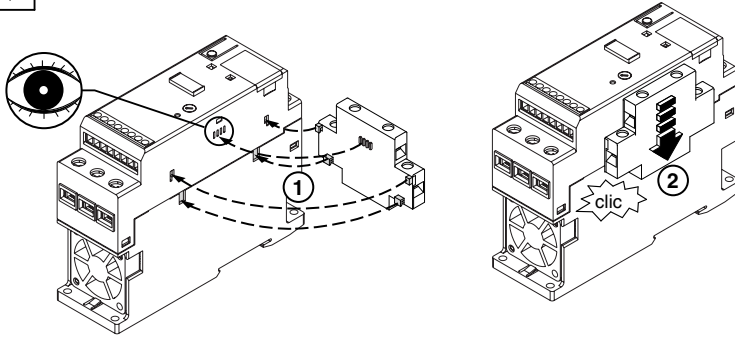

**ATTENTION:** To prevent electrical shock, disconnect from power source before installing or servicing.

**Installation**



Page 1 (Front)

**Removal**

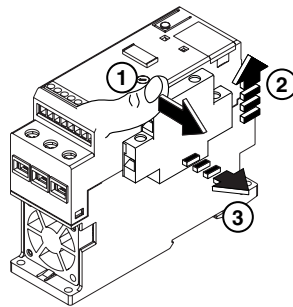

**Wire Sizes**

13 14			1 x 1 ... 2.5 mm <sup>2</sup> 2 x 1 ... 2.5 mm <sup>2</sup> No. 16 ... 12 AWG	
			1 x 1 ... 4 mm <sup>2</sup> 2 x 1 ... 4 mm <sup>2</sup> No. 16 ... 12 AWG	

41053-178-01 (1)  
 Printed in South Korea



Page 2 (Back)