

sprecher+schuh PCS MOV Protective Module Installation Instructions
(Cat PCP-147- _____)



WARNING

To prevent electrical shock, disconnect from power source before installing or servicing.
Protective modules must **NOT** be mounted on the load side when used with controllers that use an inside-the-delta motor connection. Installing them with an inside-the-delta motor connection will result in immediate damage to the protective module.

Installation

1

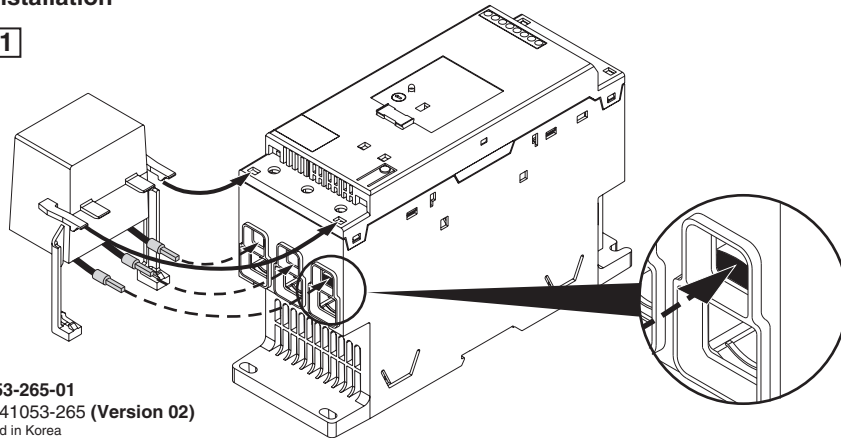

41053-265-01
DIR 41053-265 (Version 02)
Printed in Korea

Page 1 (Front)

Installation (Cont'd)

2

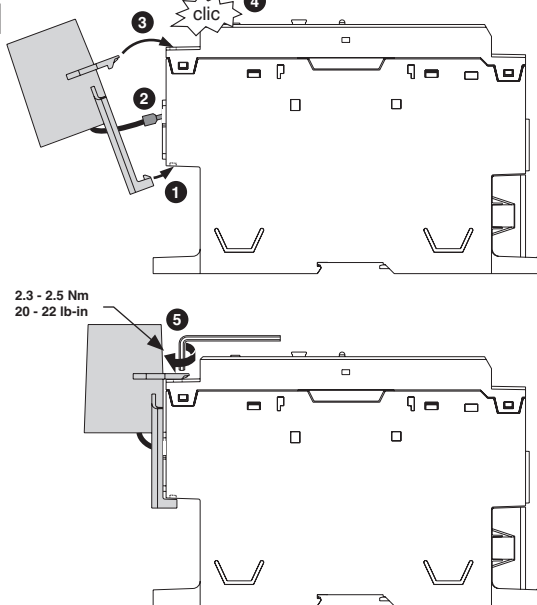

41053-265-01
DIR 41053-265 (Version 02)
Printed in Korea

sprecher+schuh

Page 2 (Back)

-01	TWO SIDES PRINTED BODY STOCK WHITE BODY INK BLACK	5" W x 4" H	2-1/2" W x 2" H
MATERIAL MASTER	MATERIAL	FLAT	FOLD
<p style="text-align: center;">Rockwell Automation</p> <p>SPRECHER+SCHUH PCS MOV PROTECTIVE MODULE INSTALLATION INSTRUCTION SHEET</p>		CONFIDENTIAL AND PROPRIETARY INFORMATION. THIS DOCUMENT CONTAINS CONFIDENTIAL AND PROPRIETARY INFORMATION OF ROCKWELL AUTOMATION, INC. AND MAY NOT BE USED, COPIED OR DISCLOSED TO OTHERS, EXCEPT WITH THE AUTHORIZED WRITTEN PERMISSION OF ROCKWELL AUTOMATION, INC.	
		Sheet	1
Dr. G. Ushakow		Date	03-15-11
		Size	Ver
		B	41053-265
			02