

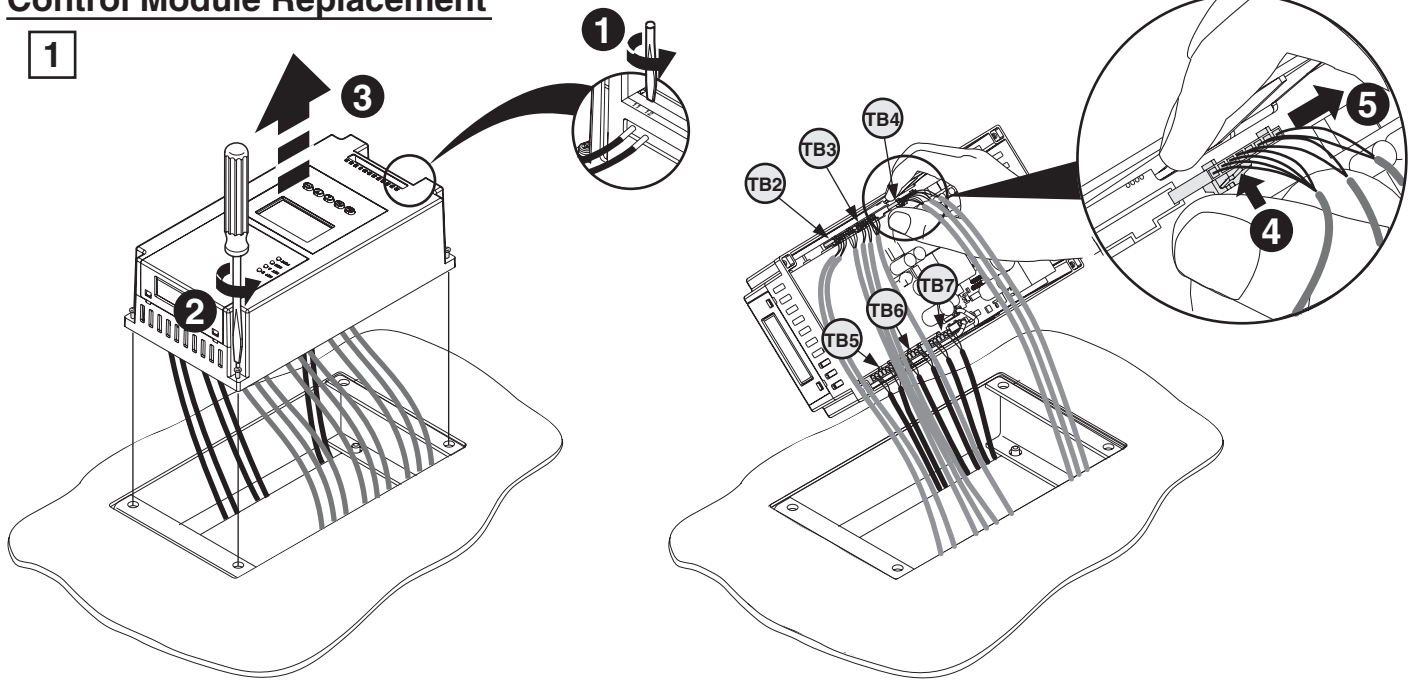

ATTENTION: To prevent electrical shock, disconnect from power source before installing or servicing. Install in suitable enclosure. Keep free from contaminants.

Control Module Replacement

1



2

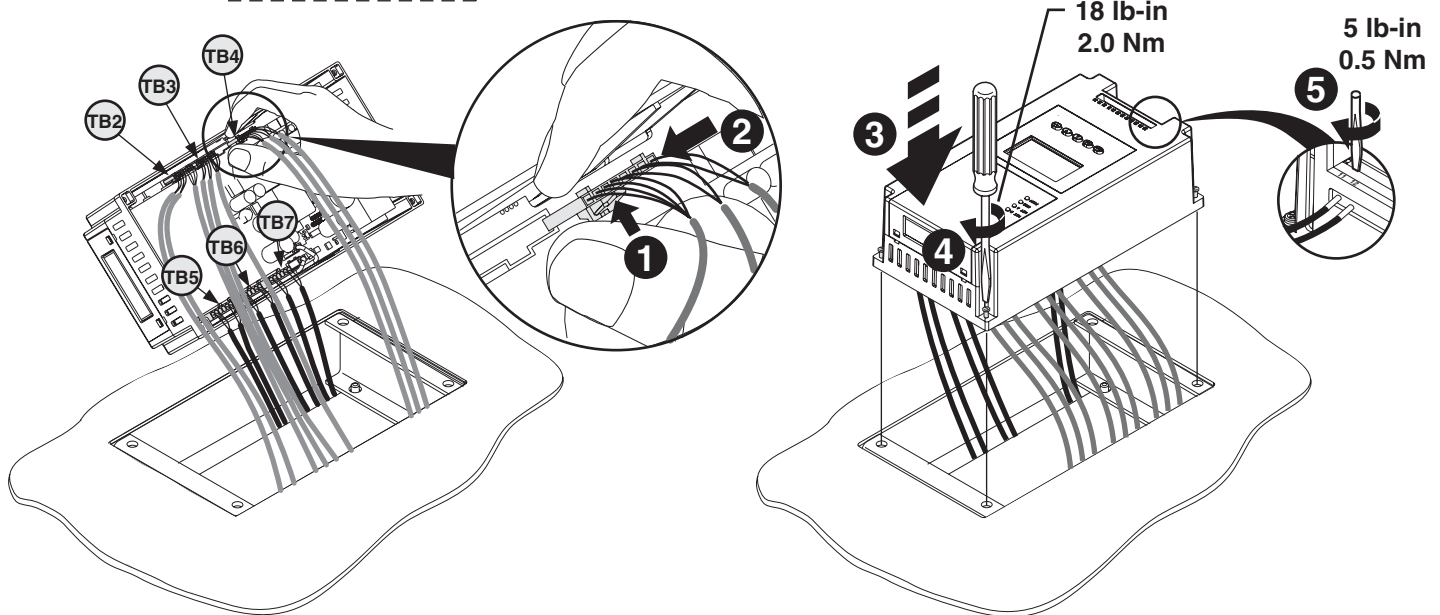
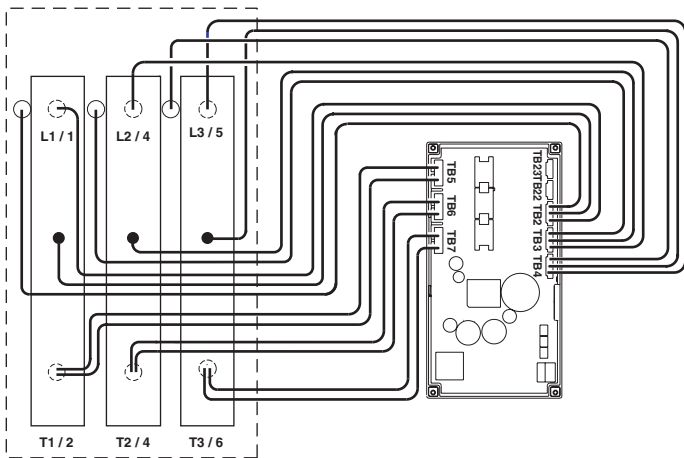

Fan Replacement

1

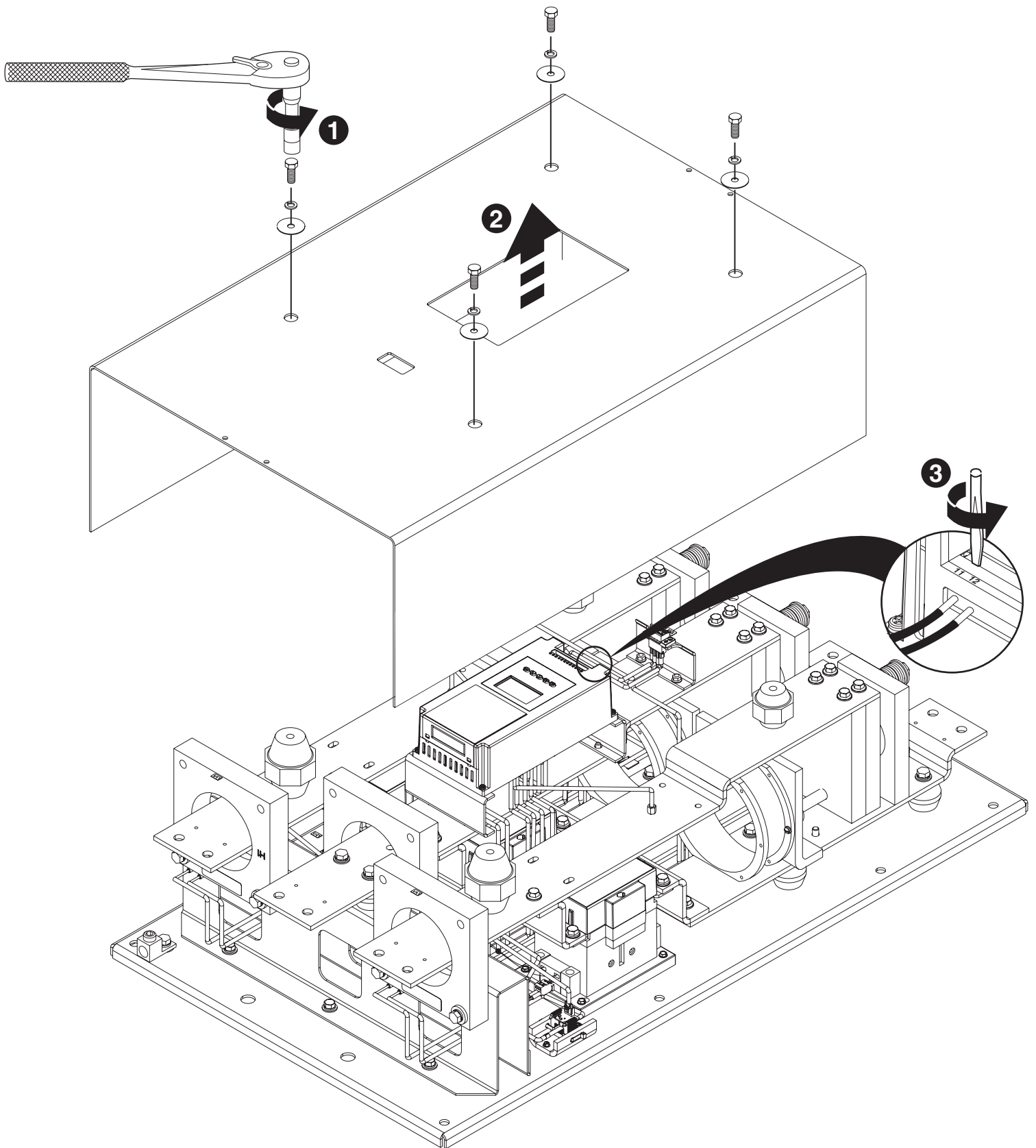

Fan Replacement (Cont'd)

2

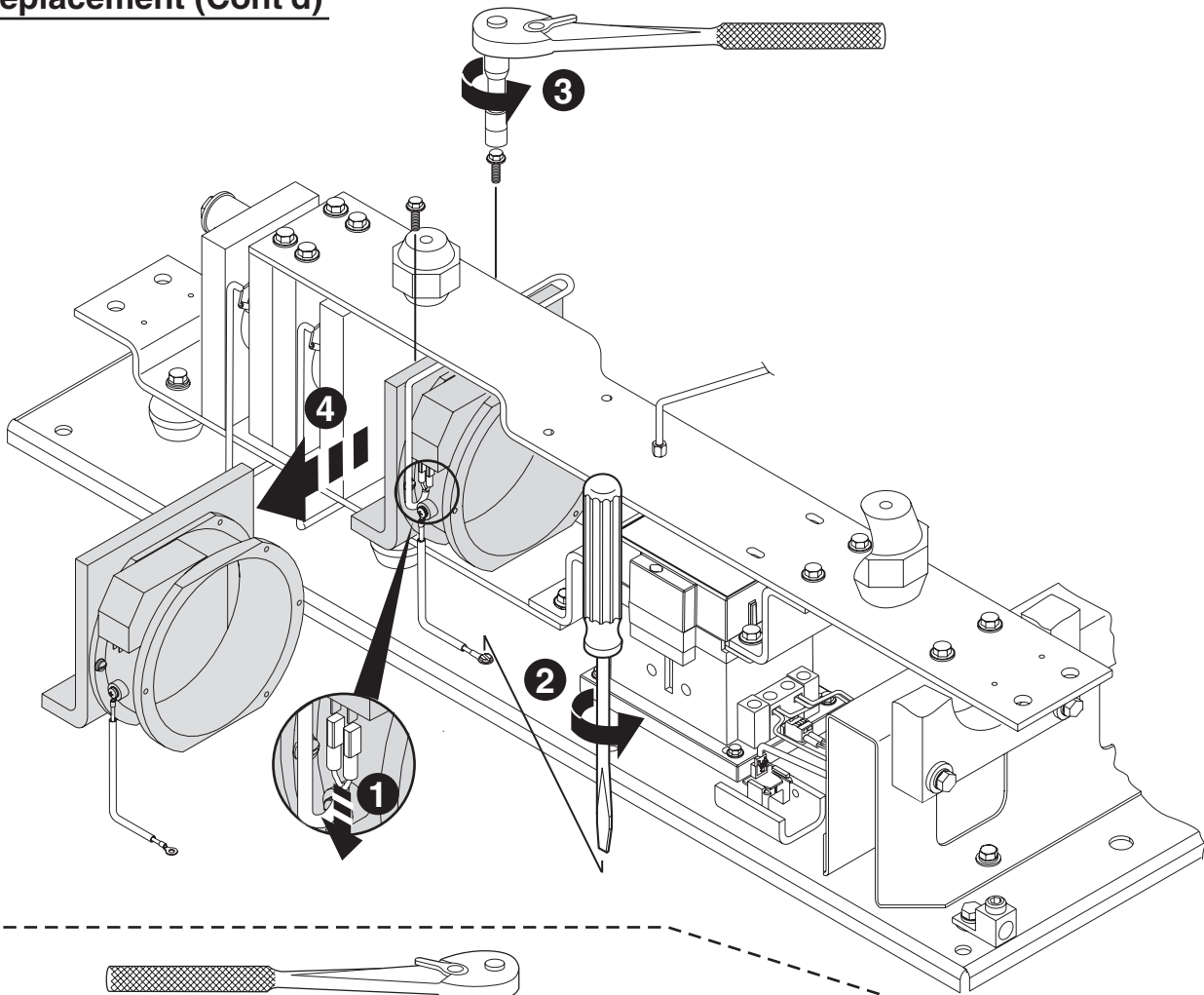

3

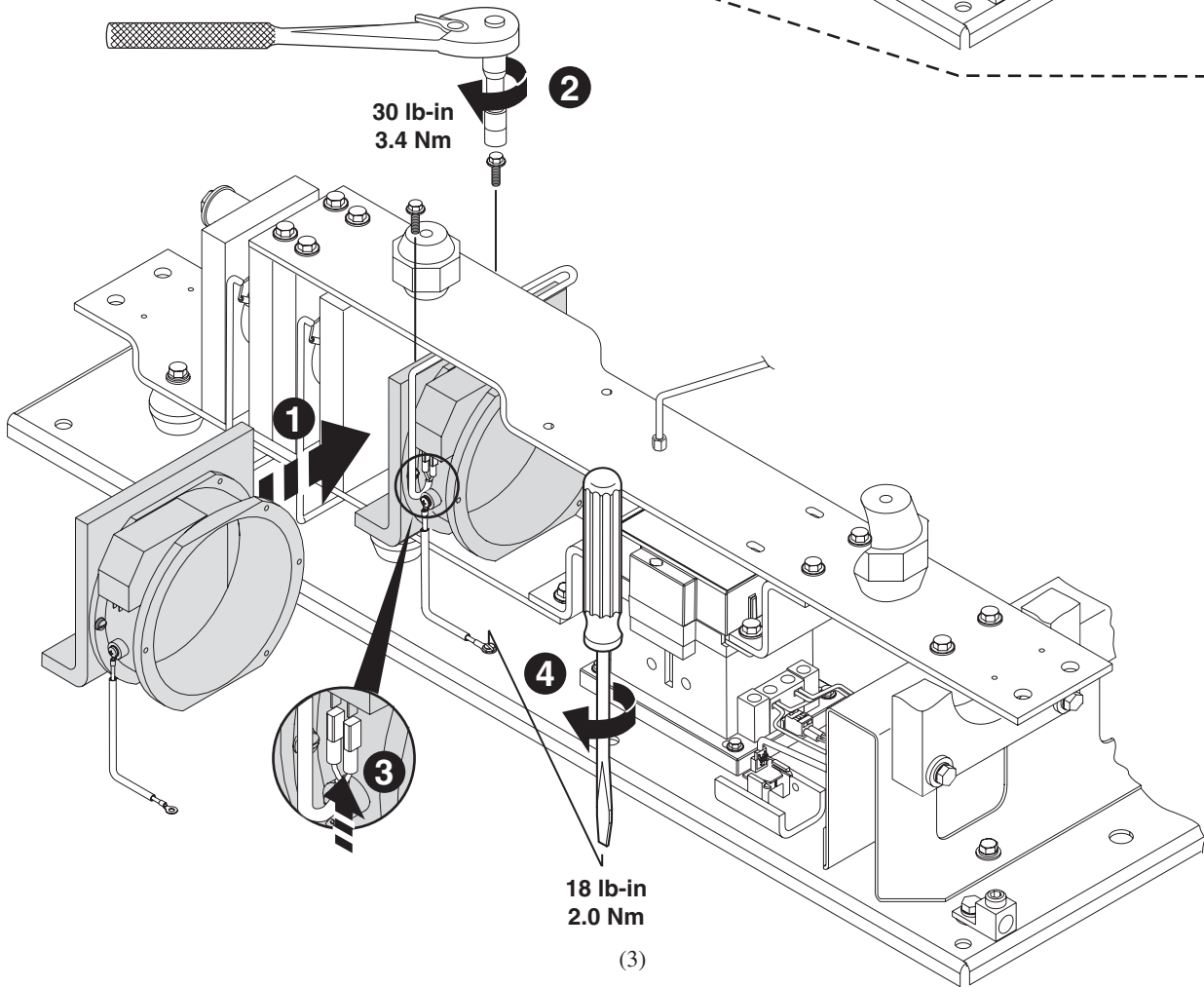

Contactor Replacement

1 Note: Cover is removed

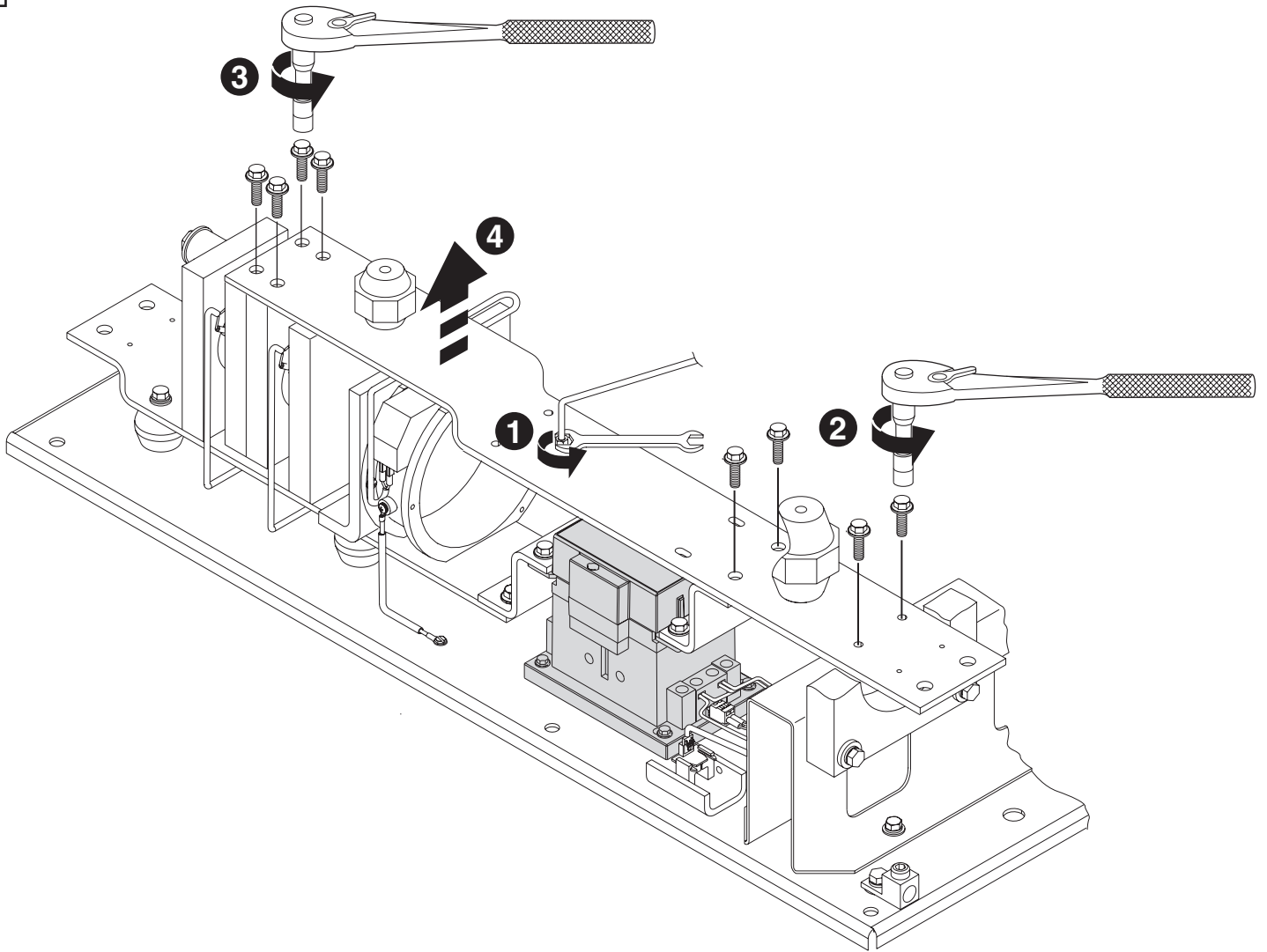

Contactors Replacement (Cont'd)

2

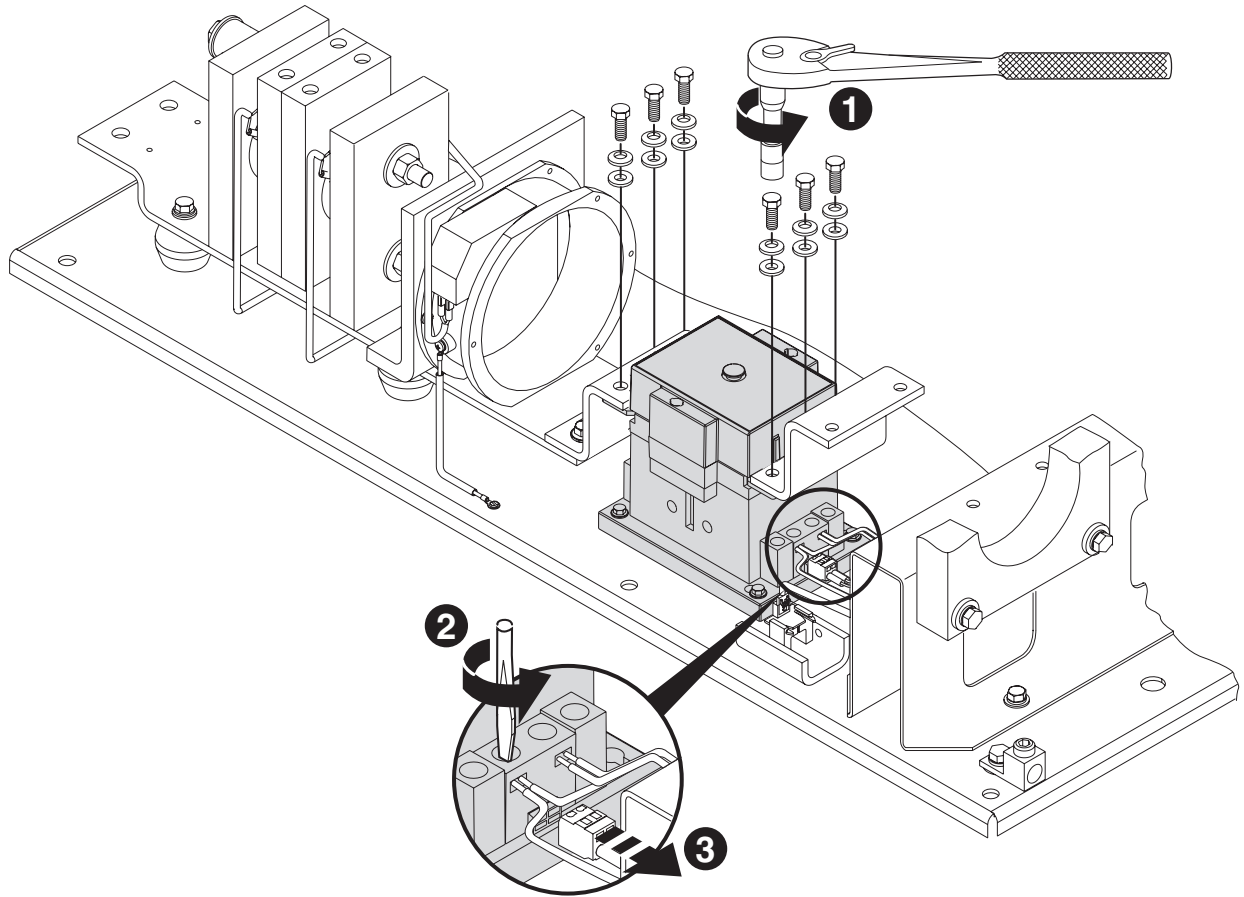

3

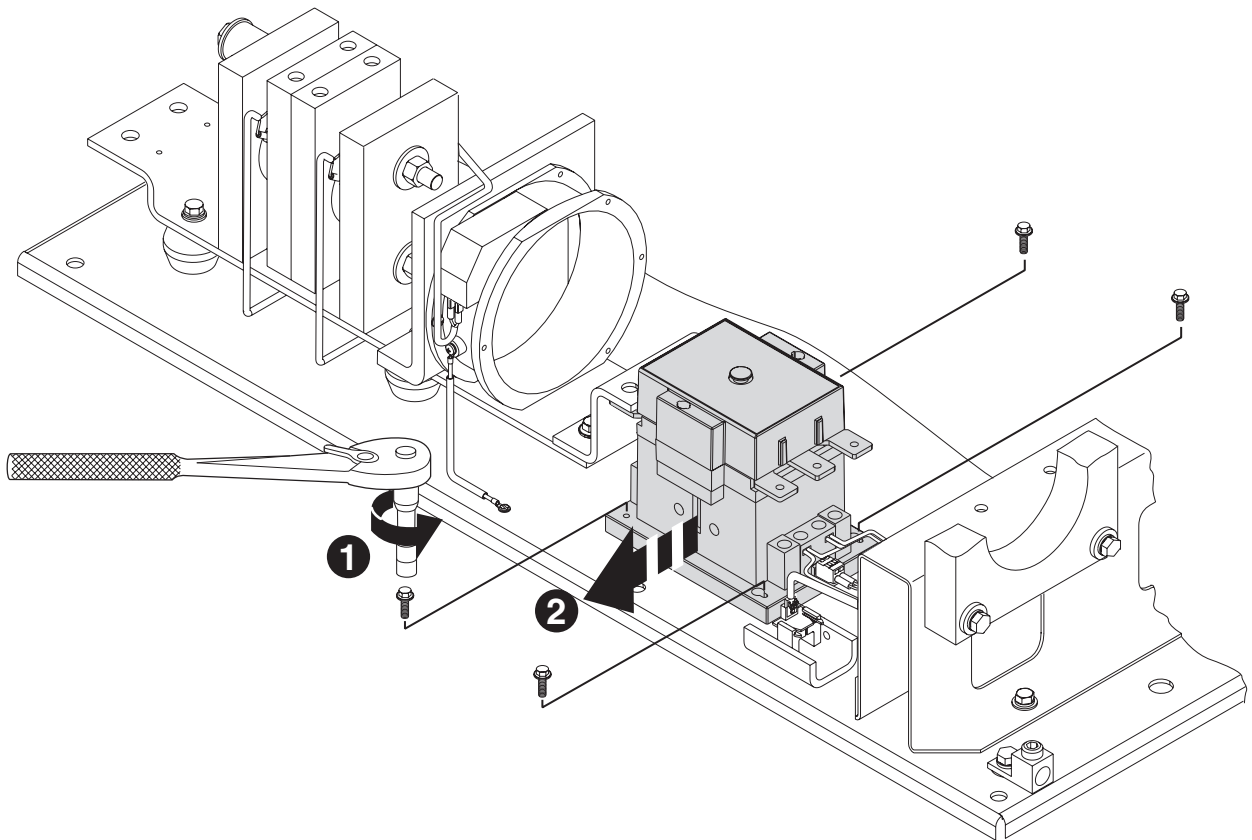

Contactors Replacement (Cont'd)

4

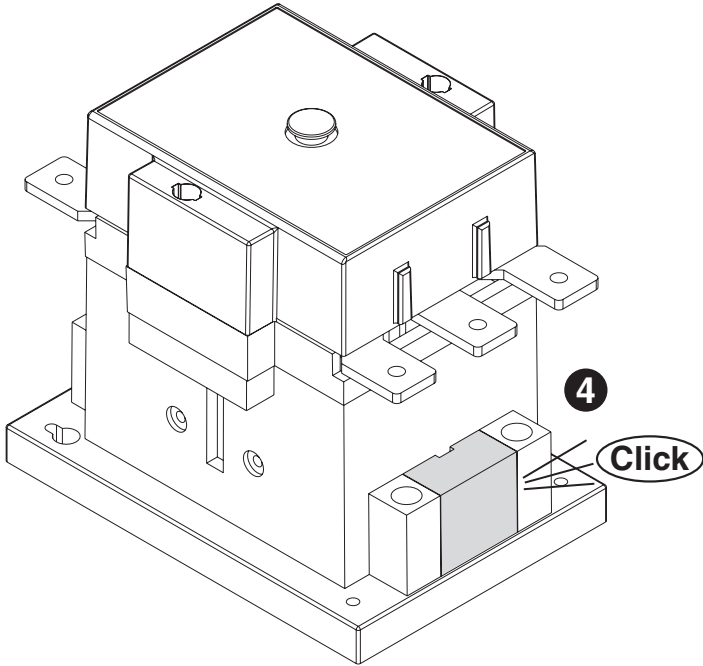
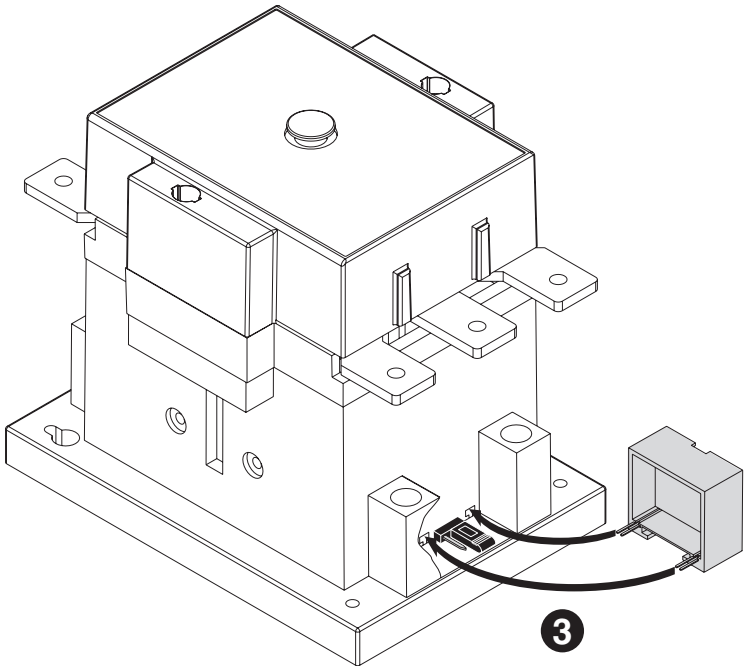
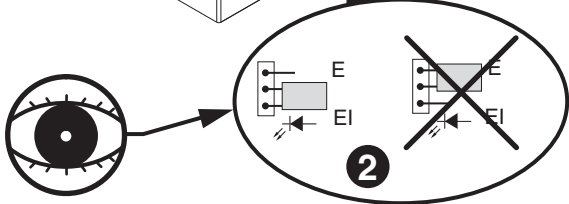
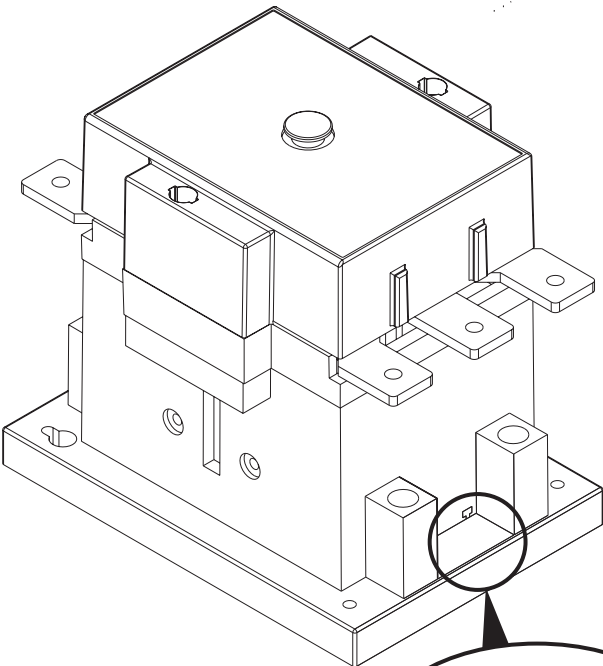
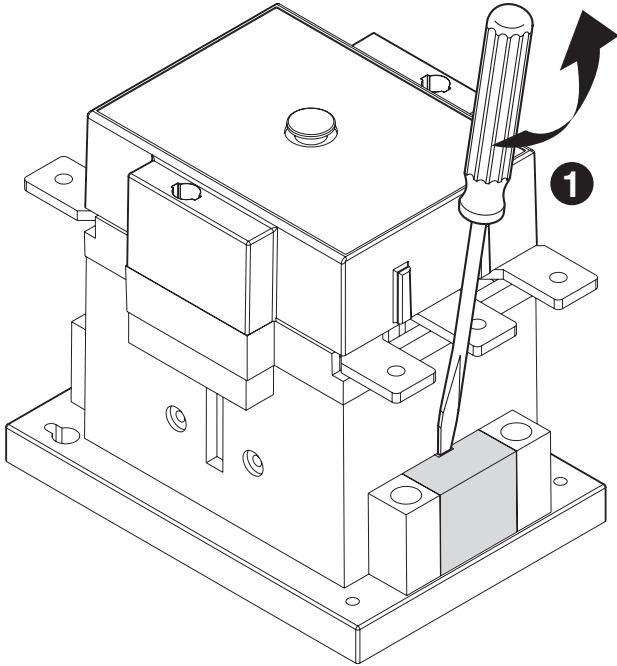

Contactors Replacement (Cont'd)

5

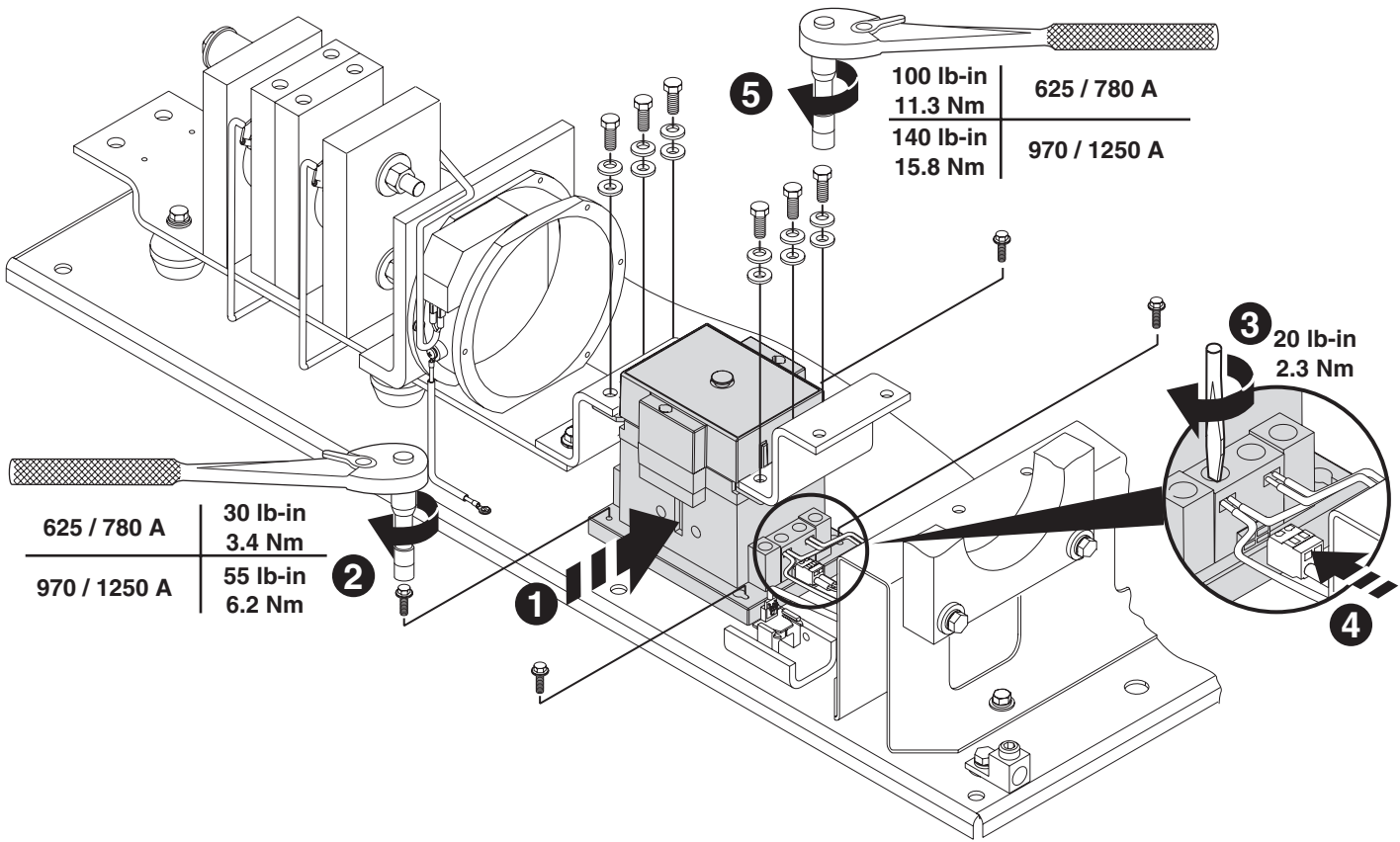

6

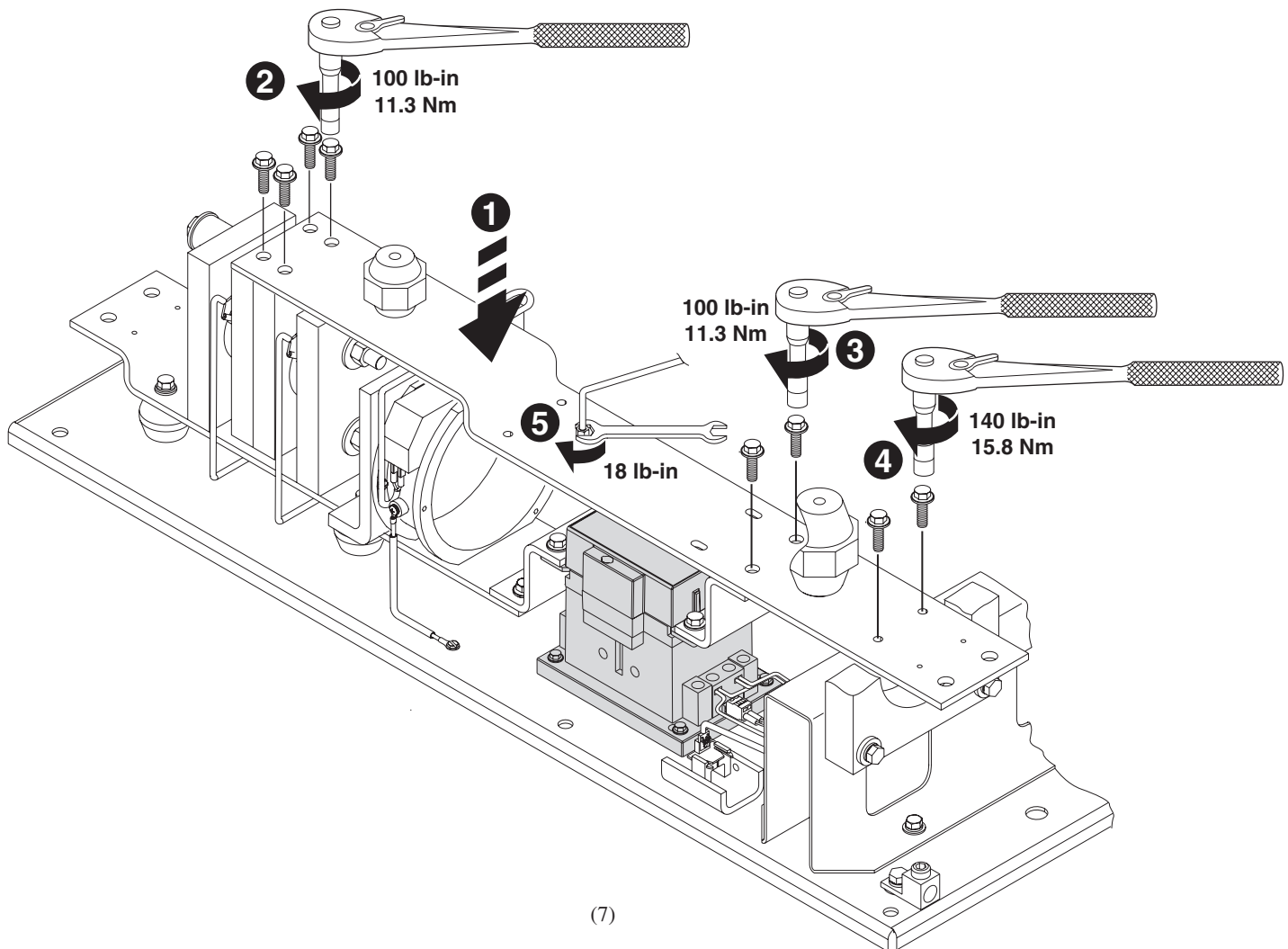

Power Pole Replacement

1 Note: Cover is removed

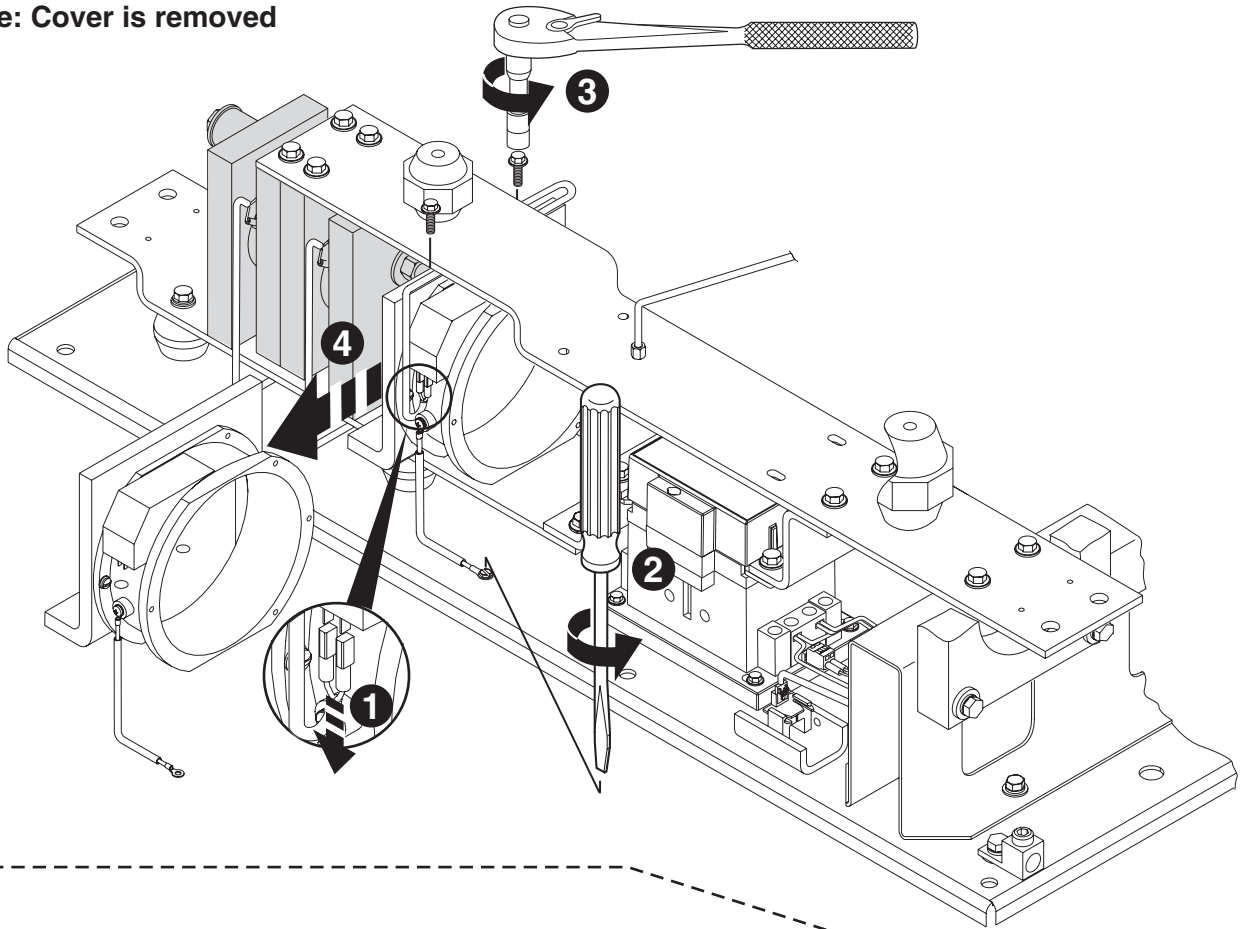

2

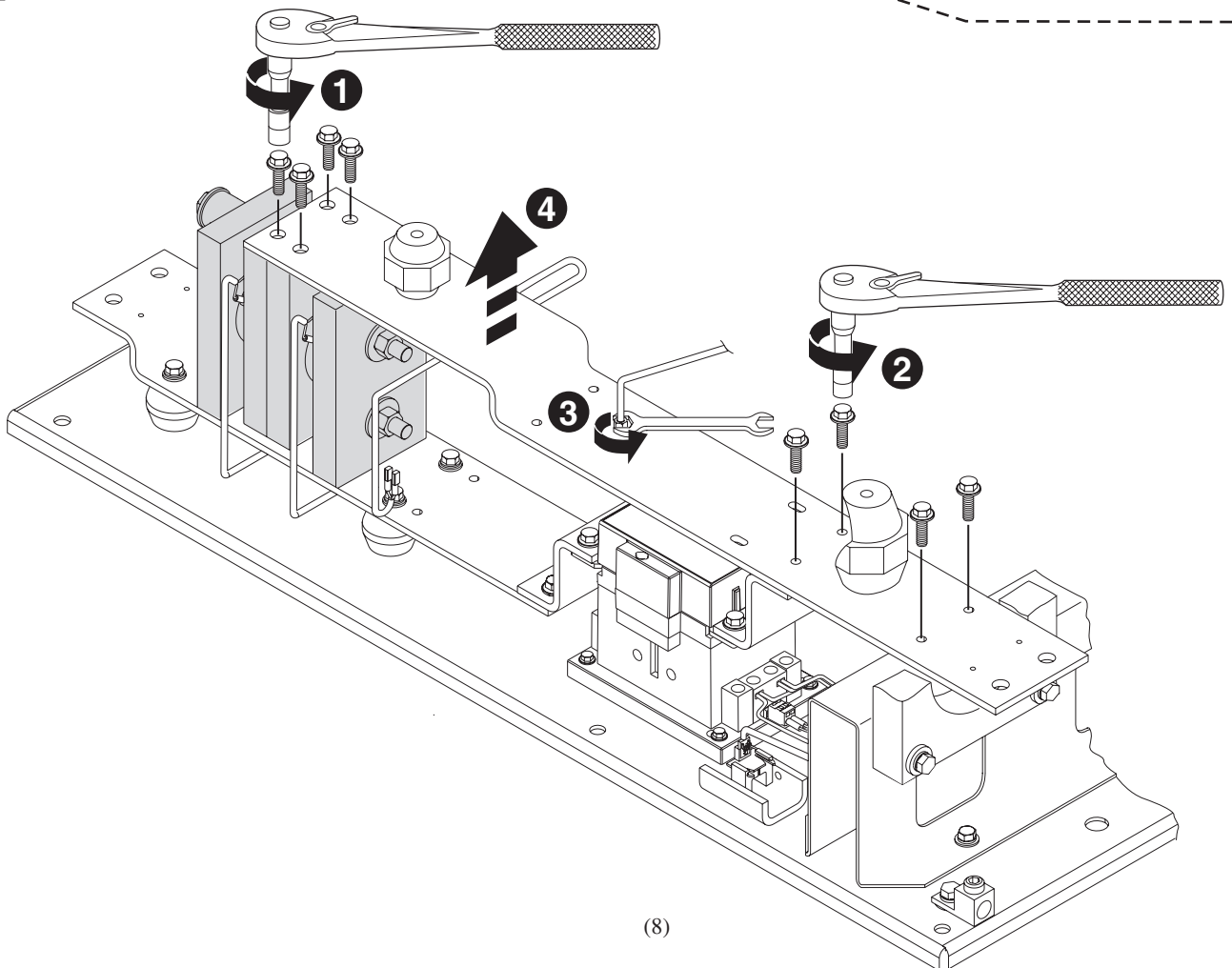

Power Pole Replacement (Cont'd)

3

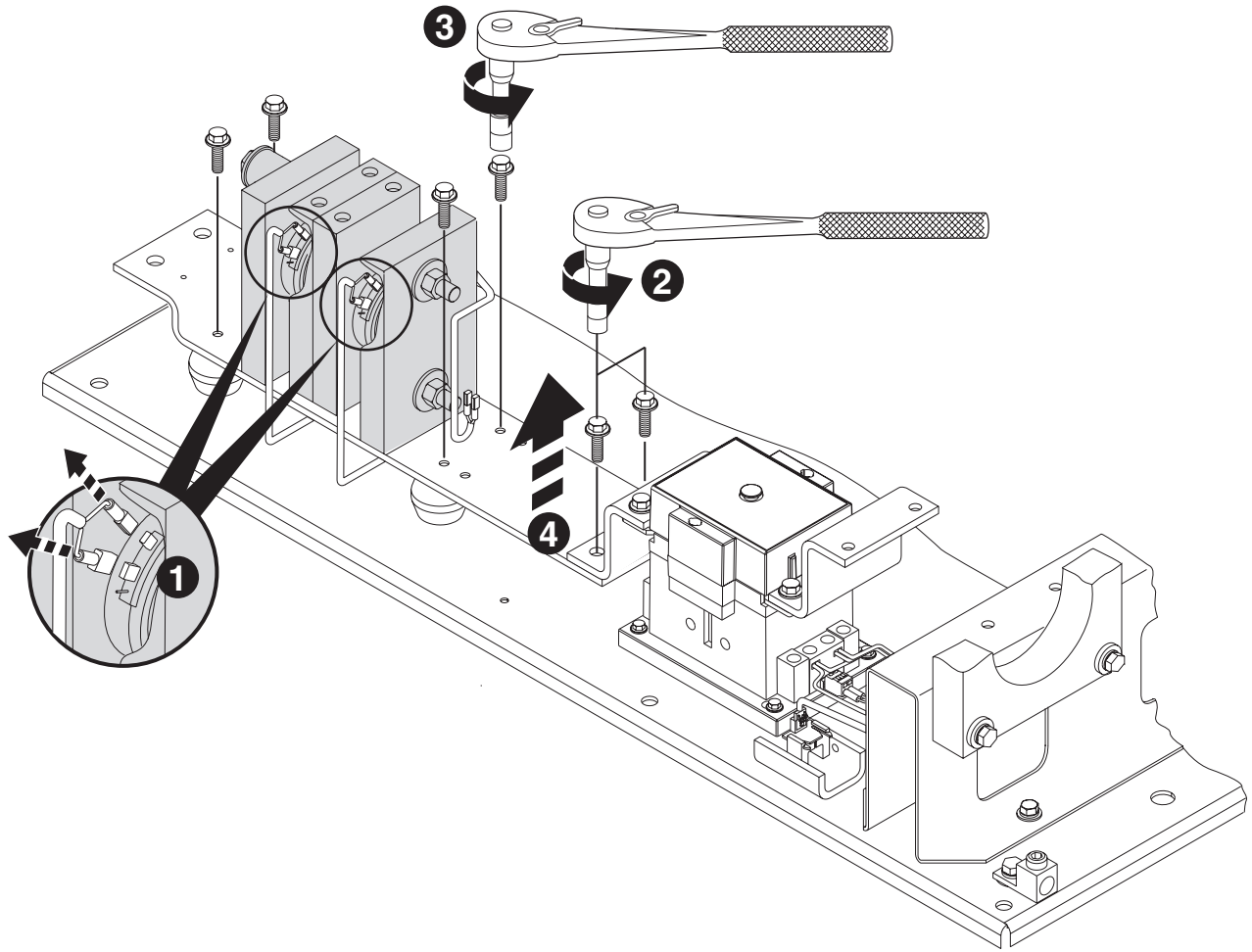

4

OLD

NEW

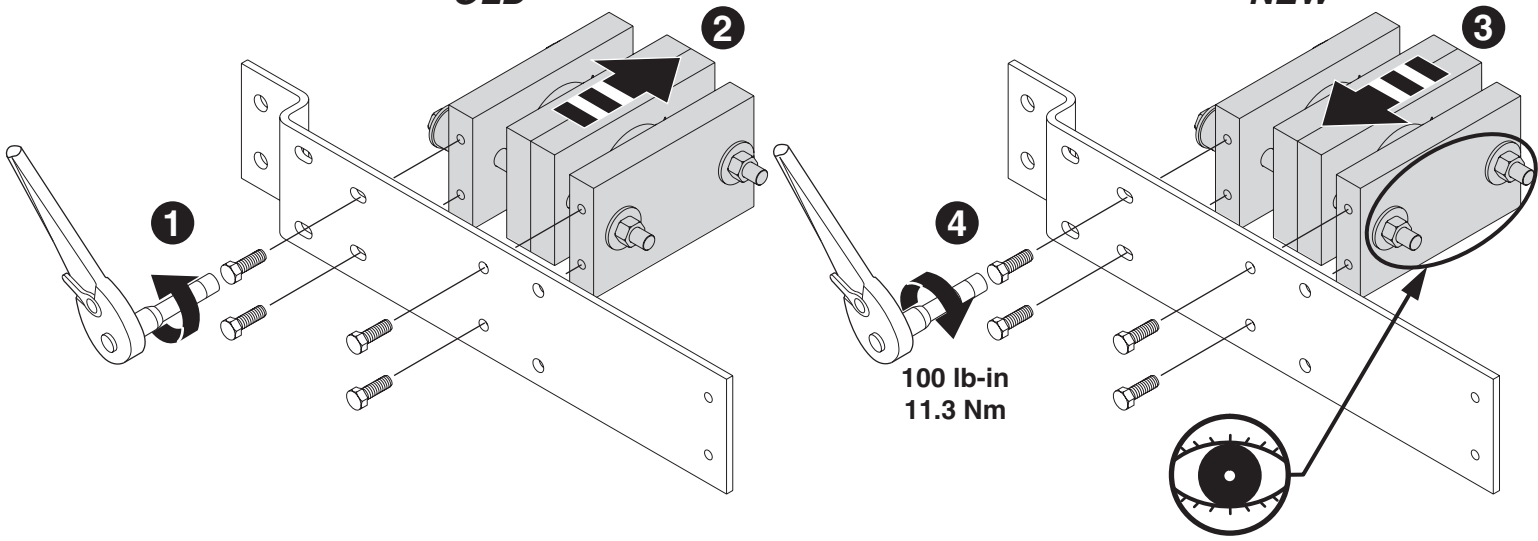

Power Pole Replacement (Cont'd)

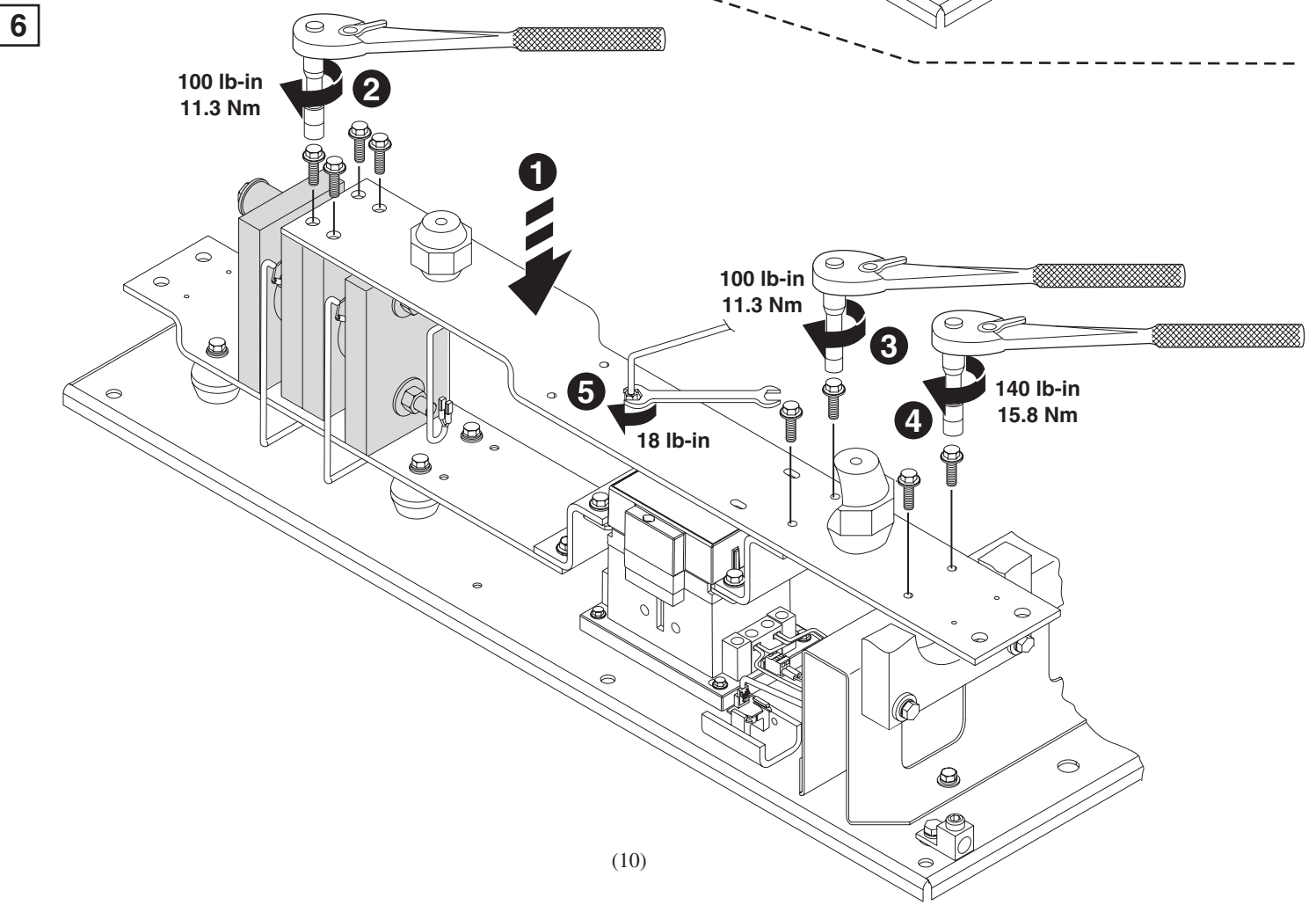
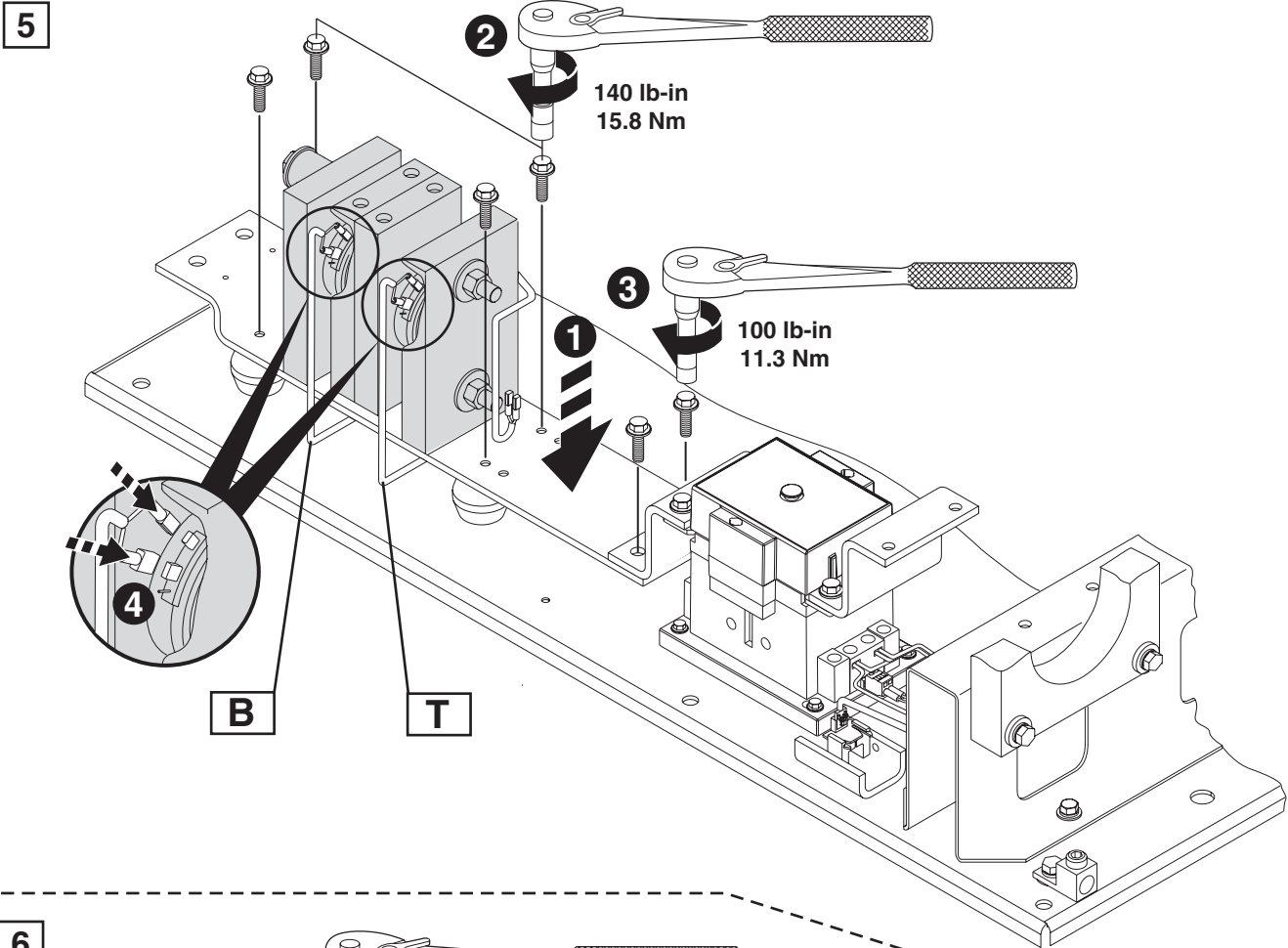

Power Pole Replacement (Cont'd)

7

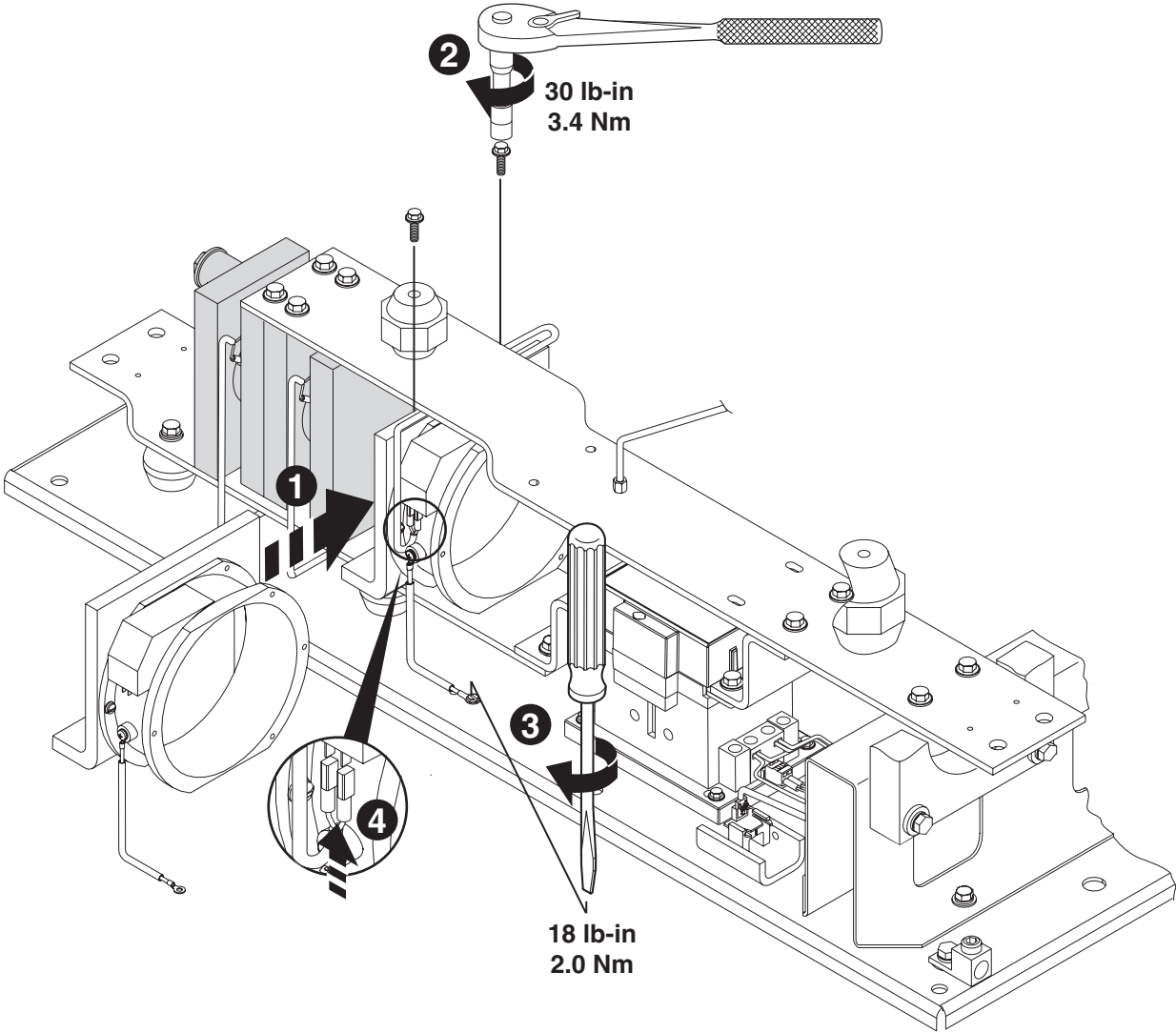

Power Pole Replacement (Cont'd)

8

