

sprecher+ schuh PFP Protective Module Installation Instructions

Rated 5-85 Amps

(Cat PFP-0085-480V, PFP-0085-600V)



ATTENTION: To prevent electrical shock, disconnect from power source before installing or servicing. Install in suitable enclosure. Keep free from contaminants.

Protective Module Installation (Line Side)

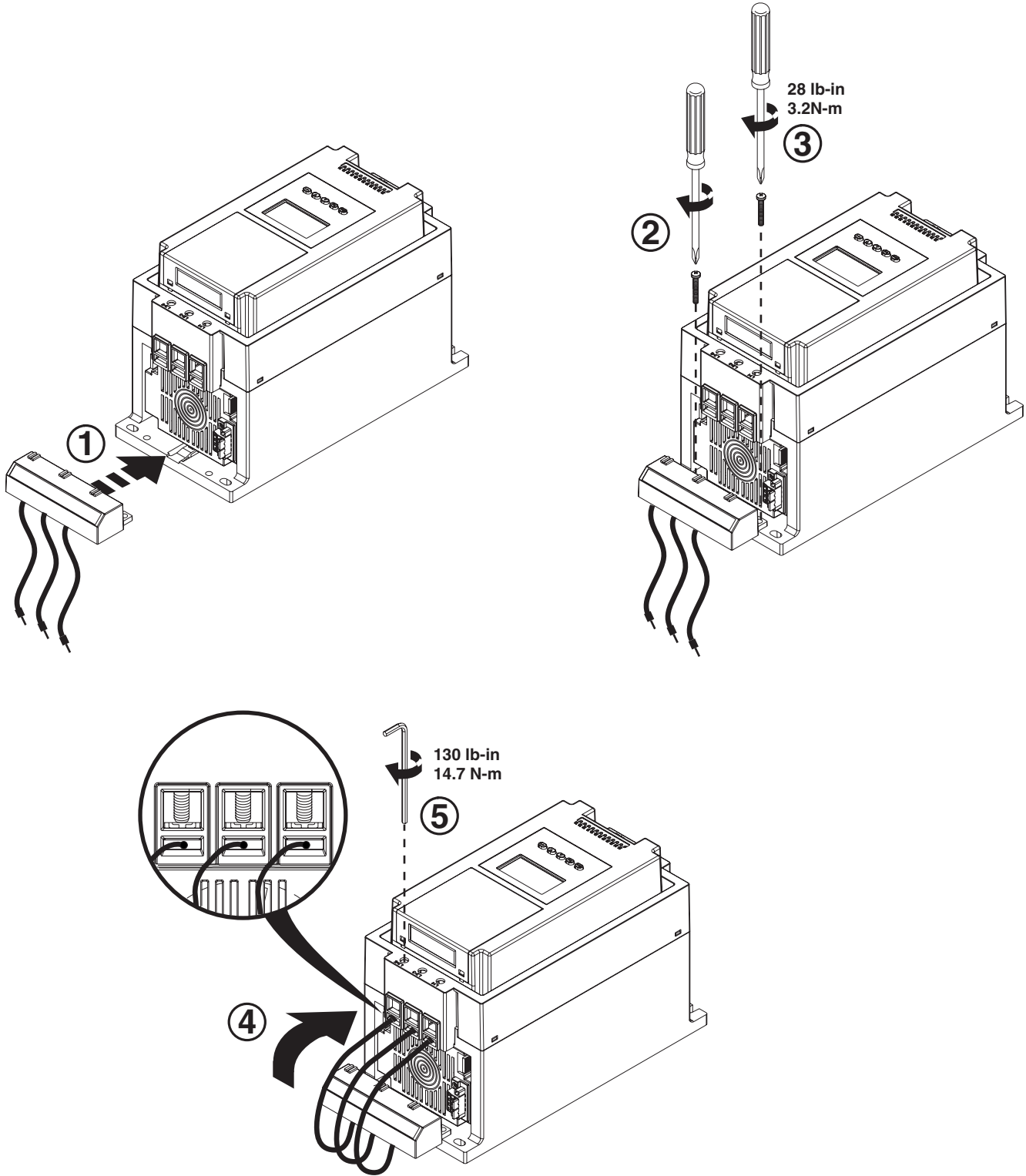

Protective Module Installation (Load Side)

