

(Cat PFL-0108\_, PFL-0135\_)

(Cat PFB, PFB-024, PFD-0251, PFD-0251-024, PFS, PFS-024)



**ATTENTION:** To prevent electrical shock, disconnect from power source before installing or servicing. Install in suitable enclosure. Keep free from contaminants.

**Control Module Removal**

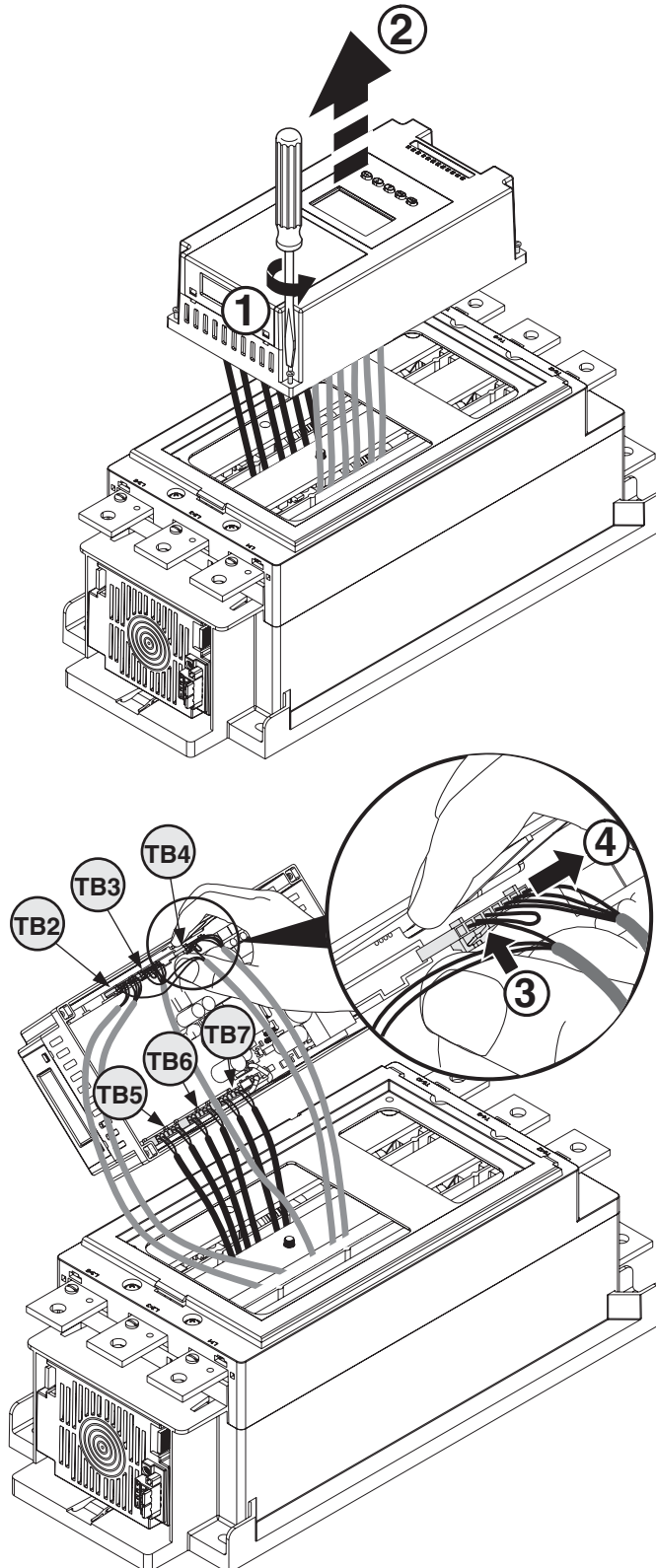

# Control Module Installation

