

Switch disconnecter, fourth pole, neutral terminal, ground terminal

Attention: To prevent electrical shock, disconnect from power source before installing or servicing

Interruttore-sezionatore, quarto polo, morsetto di neutro, morsetto di terra

Attenzione: Per prevenire infortuni, togliere tensione prima dell'installazione e manutenzione

Sectionneur de charge, quatrième pole, borne de neutre, borne de terre

Attention: Avant le montage et la mise en service, couper l'alimentation secteur afin d'éviter tout accident.

Interruttore-seccionadore, 4° polo, borna de neutro, borna de tierra

Atención: Desconectar la alimentación eléctrica antes de realizar el montaje y la puesta en servicio, con el objeto de evitar accidentes

Lastschalter, 4° Pol, Neutraleiterklemme Schutzleiterklemme

Achtung: Vor Installations oder Servicearbeiten Stromversorgung unterbrechen um Unfälle zu vermeiden

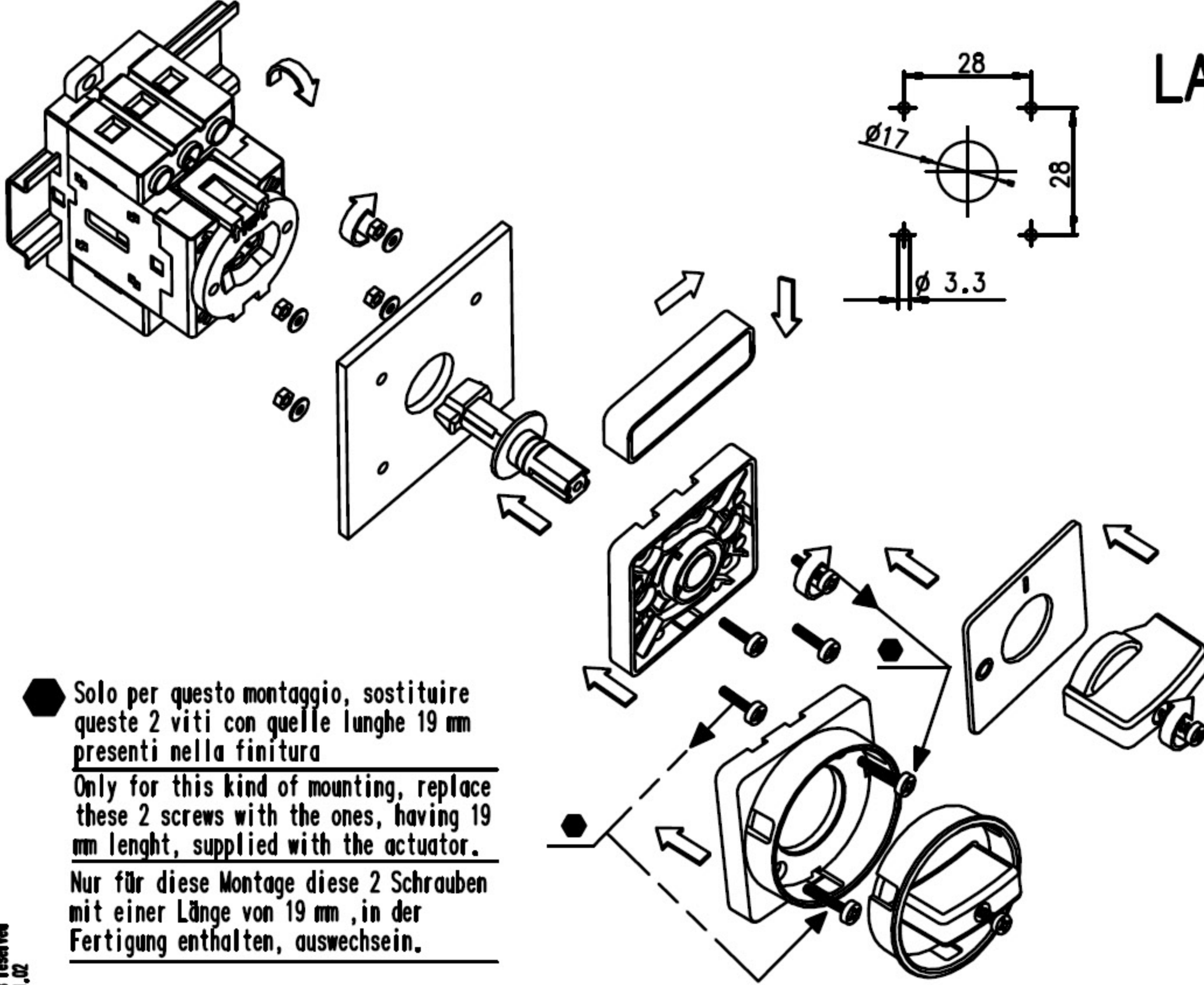

LA 7

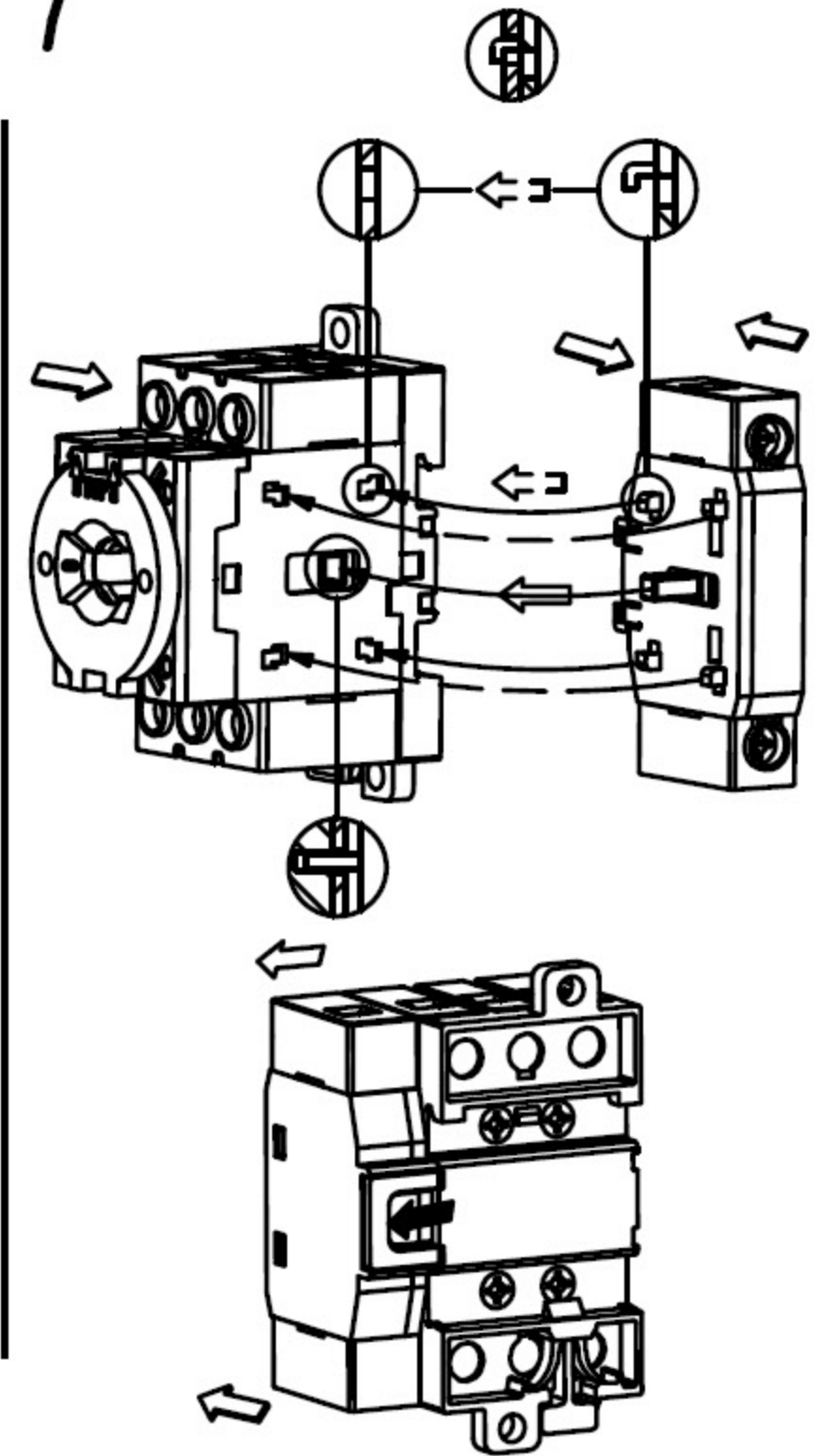

● Solo per questo montaggio, sostituire queste 2 viti con quelle lunghe 19 mm presenti nella finitura

Only for this kind of mounting, replace these 2 screws with the ones, having 19 mm length, supplied with the actuator.

Nur für diese Montage diese 2 Schrauben mit einer Länge von 19 mm, in der Fertigung enthalten, auswechseln.

Technical changes reserved
14.00.912-01/01.02
Edition 2

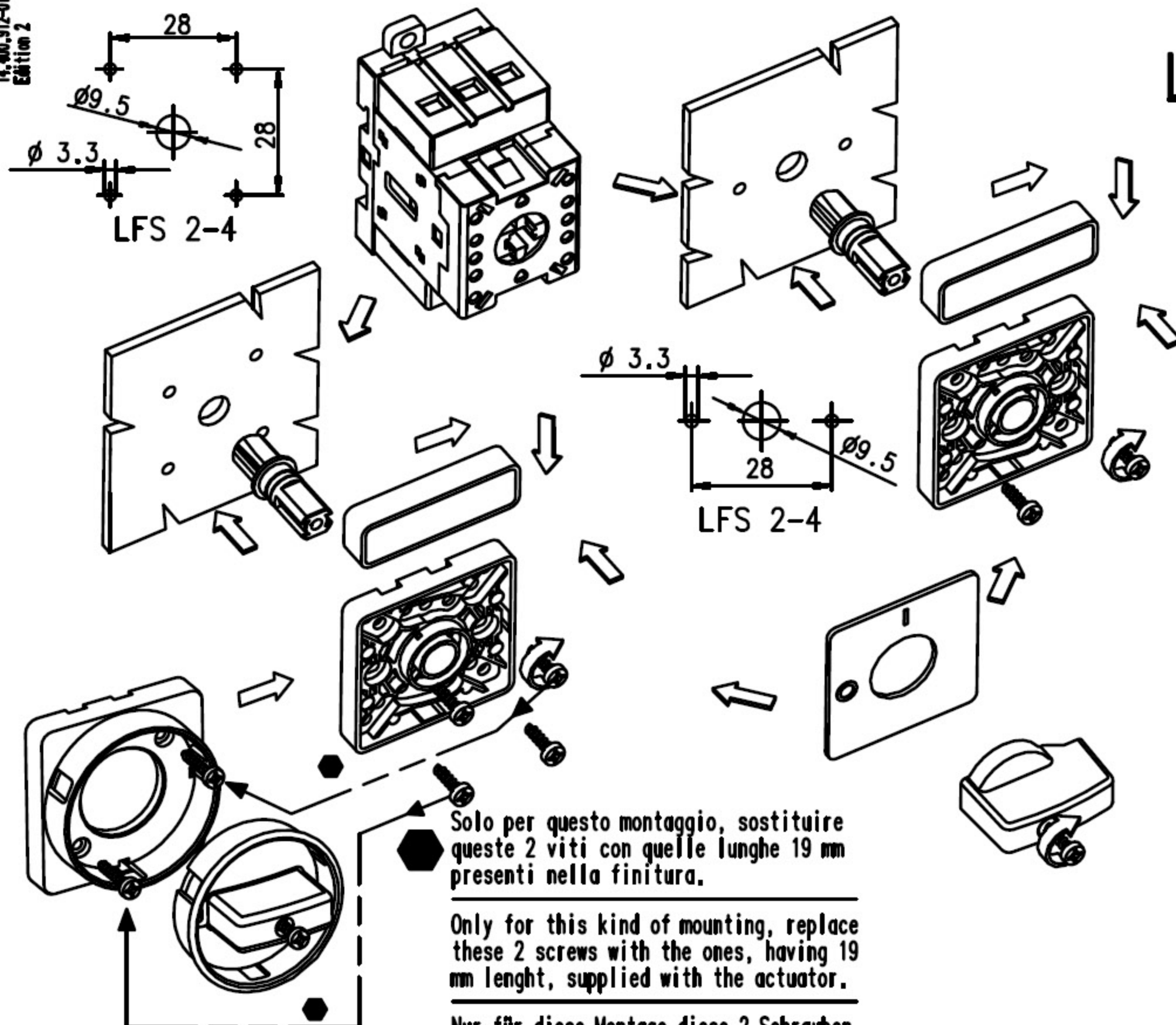

LE 7

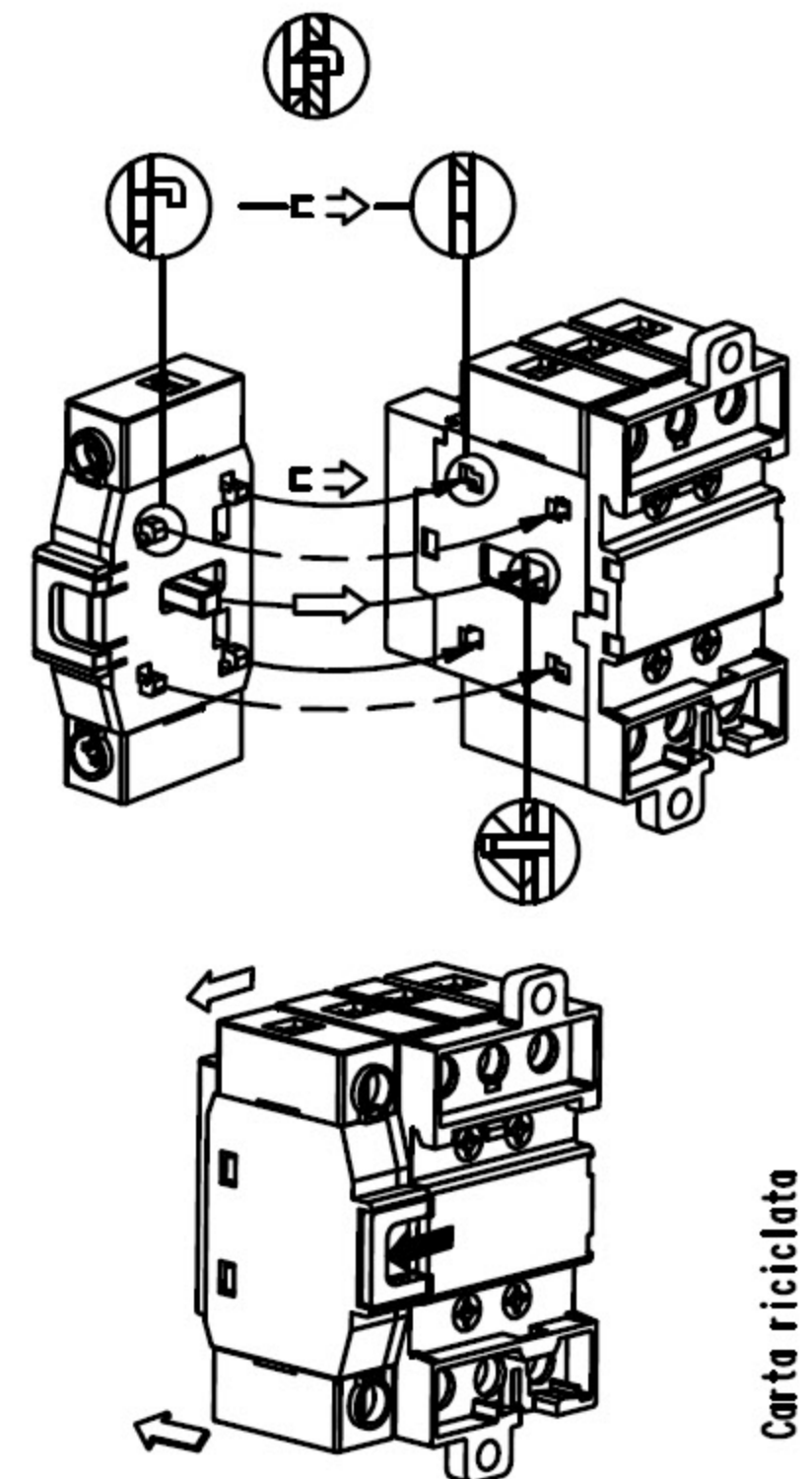

● Solo per questo montaggio, sostituire queste 2 viti con quelle lunghe 19 mm presenti nella finitura.

Only for this kind of mounting, replace these 2 screws with the ones, having 19 mm length, supplied with the actuator.

Nur für diese Montage diese 2 Schrauben mit einer Länge von 19 mm, in der Fertigung enthalten, auswechseln.

TYPE	AC21A	IEC VDE BS	AC23A			GENERAL USE	UL - CSA		WIRE	TORQUE	
			V~	230	400		690	MOTOR STARTING			FUSE (A)
L7-16	690V 16A	Ui 690V	kW	5.5	7.5	7.5	600 V ac 16A	V~	25	60/75°C Cu WIRE ONLY	12.4lb-in 1.4Nm
			Hp	1	2	3		5			

*These devices are suitable for use on a circuit of delivering not more than 5000 rms symmetrical amperes, 600 V ac max. when protected by class K5 fuses.

Suitable as motor disconnect

ANSCHLUSSPLAN - WIRING DIAGRAMS - SCHEMA DE CONNEXION - SCHEMI DI COLLEGAMENTO

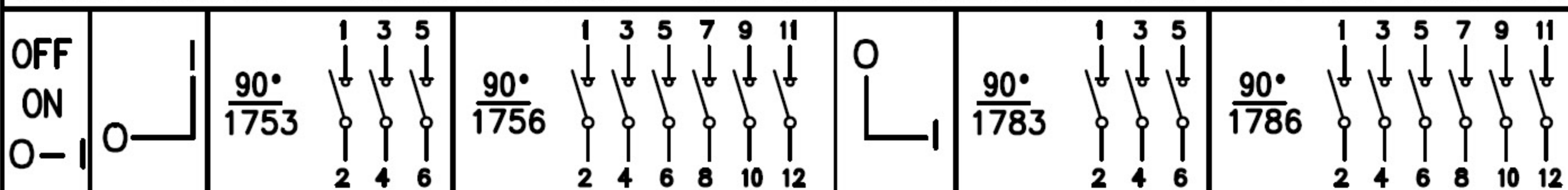

LE 7... Mit Zubehör - With accessories - Avec accessoires - Con accessori

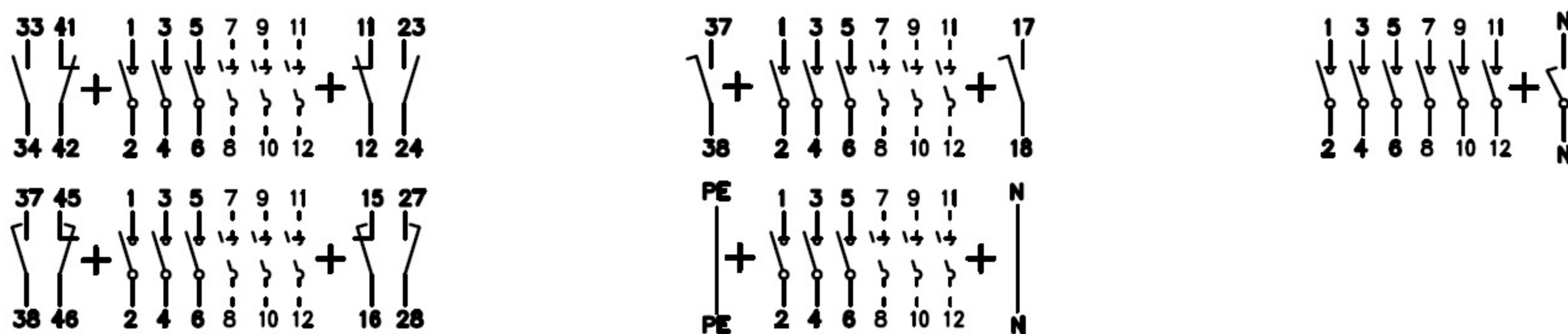

LA 7... Mit Zubehör - With accessories - Avec accessoires - Con accessori

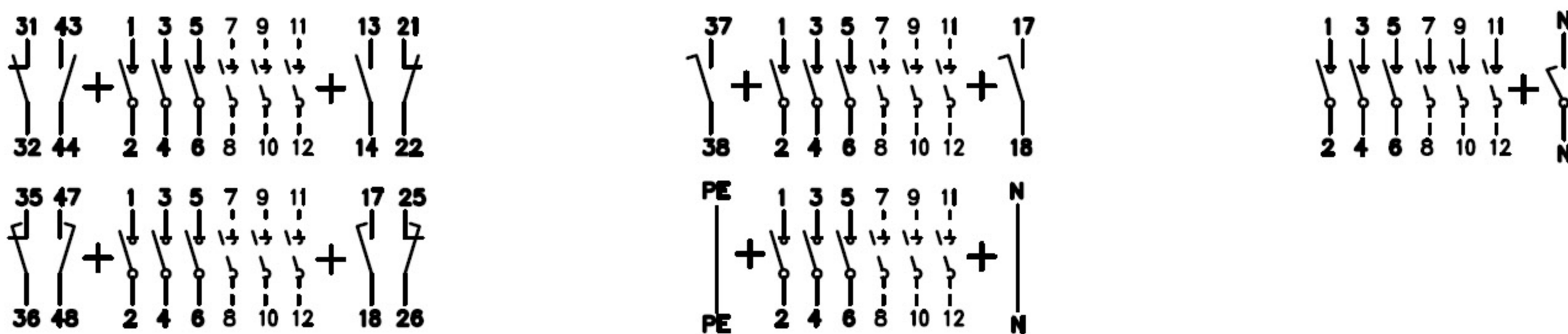

Changeover
with 0

1-0-2

90°
3753

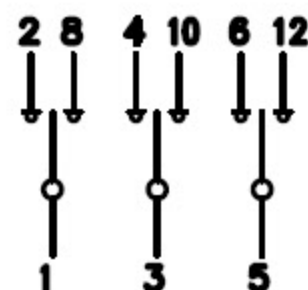

LE 7... Mit Zubehör - With accessories - Avec accessoires - Con accessori

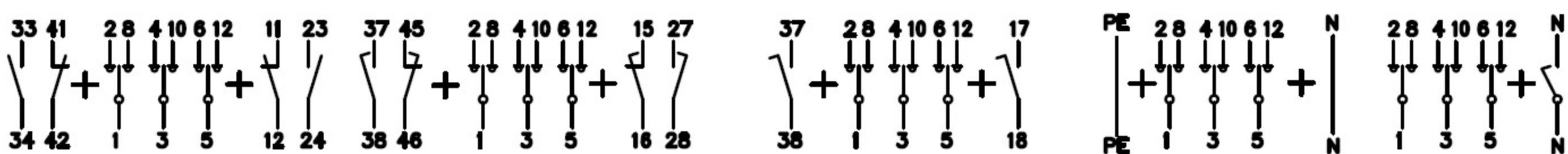

LA 7... Mit Zubehör - With accessories - Avec accessoires - Con accessori

