

Auxiliary Switch
 Contact Auxiliare
 Hilfskontakt
 Contatto Ausiliario
 Contacto Auxiliar
 (Cat L9-ABH12)



Installation
 Montage
 Montaggio
 Instalación

	WARNING	To prevent electrical shock, disconnect from power source before installing or servicing.
	AVERTISSEMENT	Avant le montage et la mise en service, couper l'alimentation secteur pour éviter toute décharge.
	WARNUNG	Vor Installations- oder Servicearbeiten Stromversorgung zur Vermeidung von elektrischen Unfällen trennen.
	AVVERTENZA	Per prevenire infortuni, togliere tensione prima dell'installazione o manutenzione.
	ADVERTENCIA	Desconéctese de la corriente eléctrica, antes de la instalación o del servicio, a fin de impedir sacudidas eléctricas.

Allowable Combinations and Positions
 Combinaisons et Positions Possible
 Zulaessige Kombinationen und Positionen
 Combinazioni e Posizioni Accettabili
 Combinaciones y Posiciones Válidas

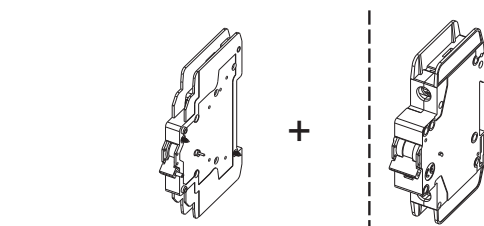

	L9-ABH12	L9-ASTA	LX-AHS3	L9-A...
Maximum	X			X
Massimo	X		X	X
Máximo		X		X
		X	X	X

H

Switches when protective device is operated manually or is tripped electrically.
 Commute lorsque le dispositif de protection est actionné manuellement ou déclenché électriquement.
 Wird betätigt, wenn die Schutzvorrichtung von Hand oder elektronisch ausgelöst wird.
 Si inserisce quando il dispositivo di protezione viene azionato manualmente oppure si attiva elettricamente.
 Se conecta cuando el dispositivo de protección se activa manualmente o se enciende de forma electrónica.

L9-ABH12

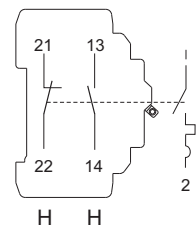

L9-... + L9-ABH12

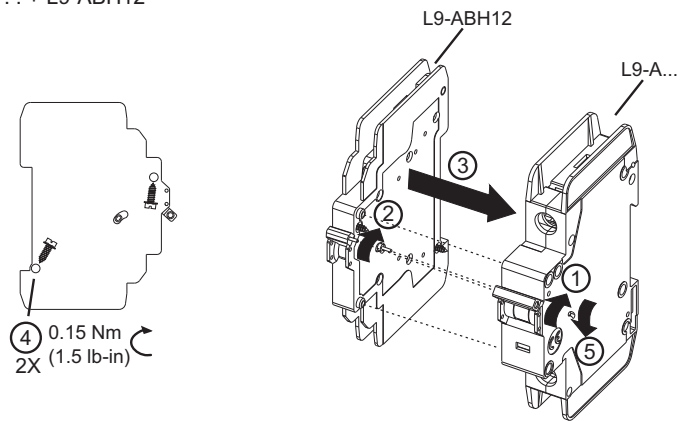

L9-ABH12

Cu Only 60/75°C					
mm ²	AWG				
1 x 0.5 - 2.5	1 x #20 - 14	10mm (0.39 in)	PZ2	0.8 x 5mm (.031 x .197 in)	1.2 Nm (10.6 lb-in)
2 x 0.5 - 2 x 2.5	2 x #20 - 2 x #14				

UL	<i>I_e</i>	<i>U_e</i>	<i>U</i> minimum = 5VDC	
489	2A 0.5A	230VAC 110VDC		
Maximum allowable circuit breaker voltage - 480Y/277VAC				

IEC/EN	<i>I_e</i>	<i>U_e</i>	<i>I_{th}</i> = 6A
60947-5-1	AC13 3A AC15 2A DC12 0.5A DC12 0.25A	250V 250V 110V 220V	
<i>U</i> minimum = 5VDC			<i>U_i</i> = 250VAC
			<i>U_{imp}</i> = 4.0kV
			Pollution Degree: 2
			IP20
			≤ 6A gL, gG